

J5880

ProLudic

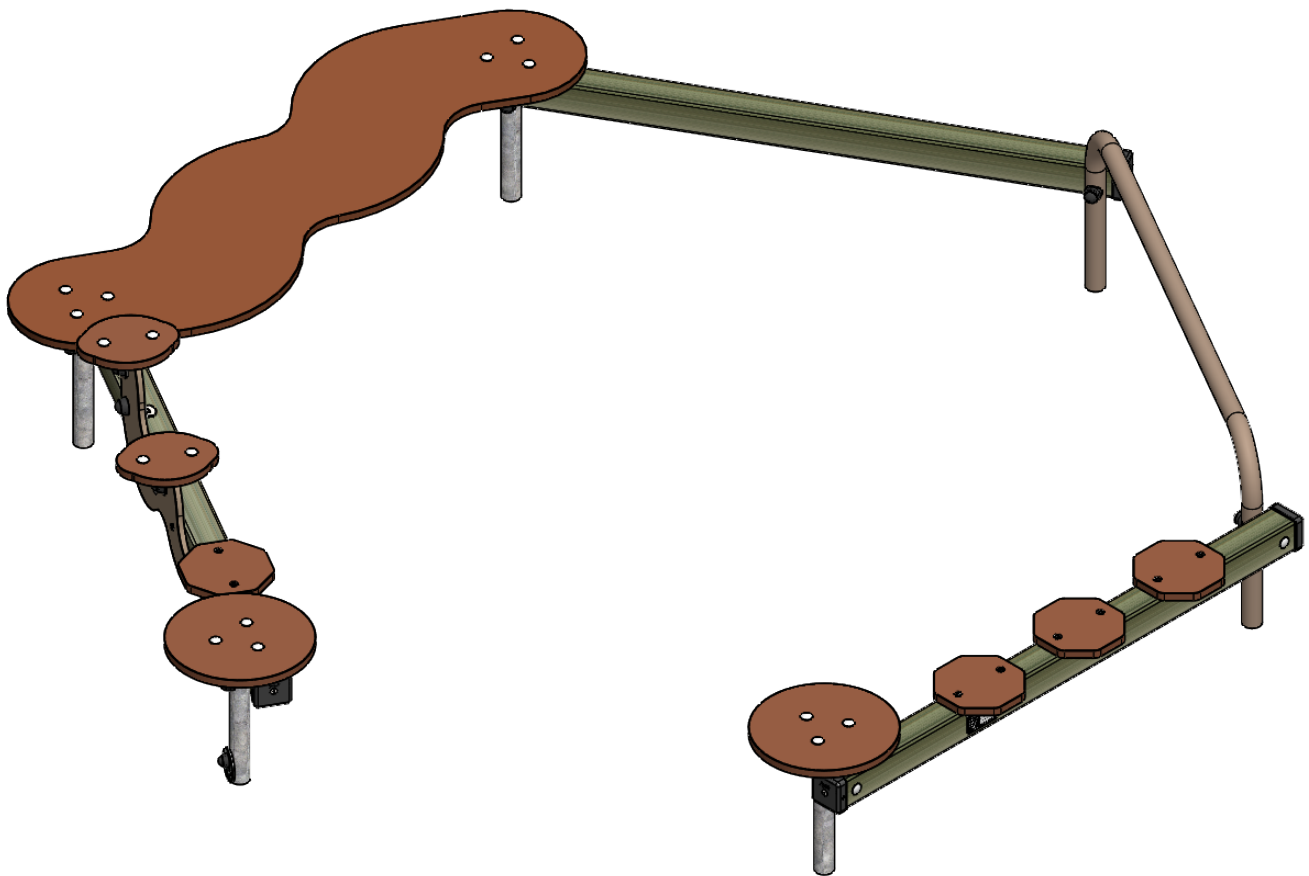

J5880

Proludic



B5803
3x

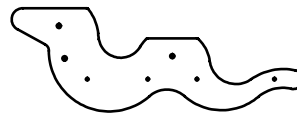

ET5891PL
1x

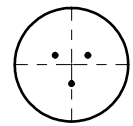

F5884
2x

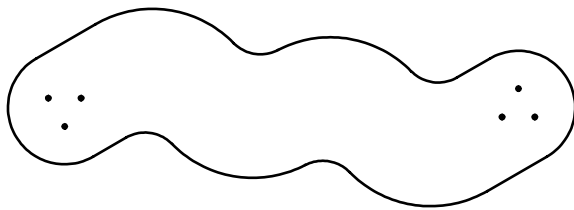

F5887
1x

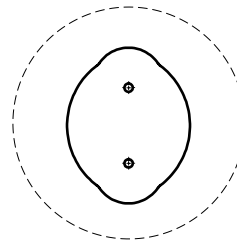

F5886
2x

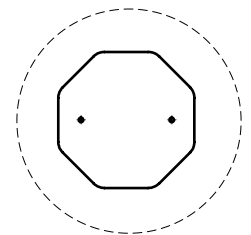

F5885
4x

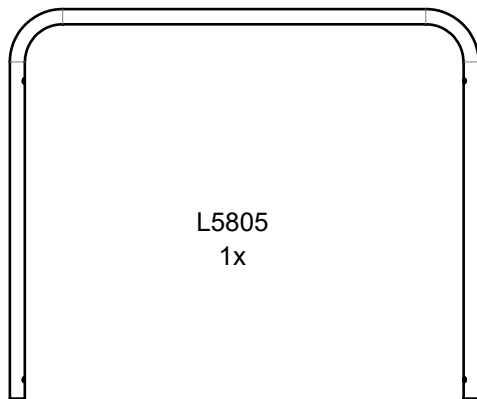

L5805
1x

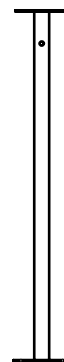

LG160
4x

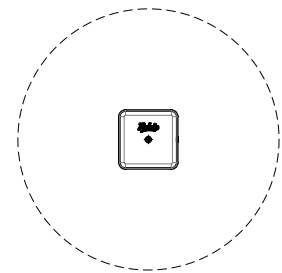

M68x68
6x

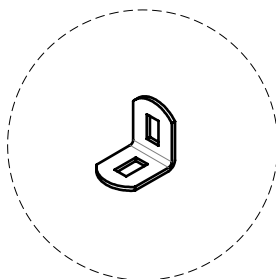

P10
1x

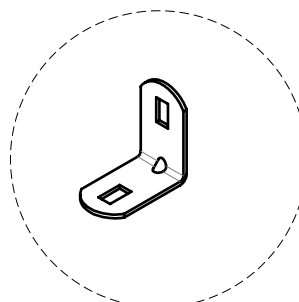

P13
4x

Réf	Qté
LA000	1
M8310N	1
M8440N	1
M10310N	19
M10440N	25
MI0002	1
MI2503N	6
VBT6x35	6
VBT7x60	13
VCBHCM10x30I	3
VECM10	24
VEFM10	3
VTH6x30A	1
VTRCC10x40	16
VTRCC10x130	8

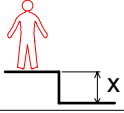
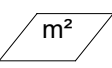

N°		
1	0.45 m	26.5 m ²

— Zone d'impact
Impact area
Area de impacto
Fallraum
Valzone

△ 0 Point de référence
Setting out point
Punto de referencia
Bezugspunkt
Referentiepunt

- - - Espace libre
Free space
Espacio libre
Freiraum
Vrije ruimte

EN1176-1 : 2017

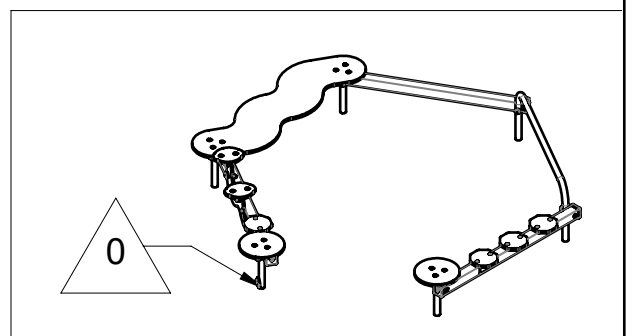
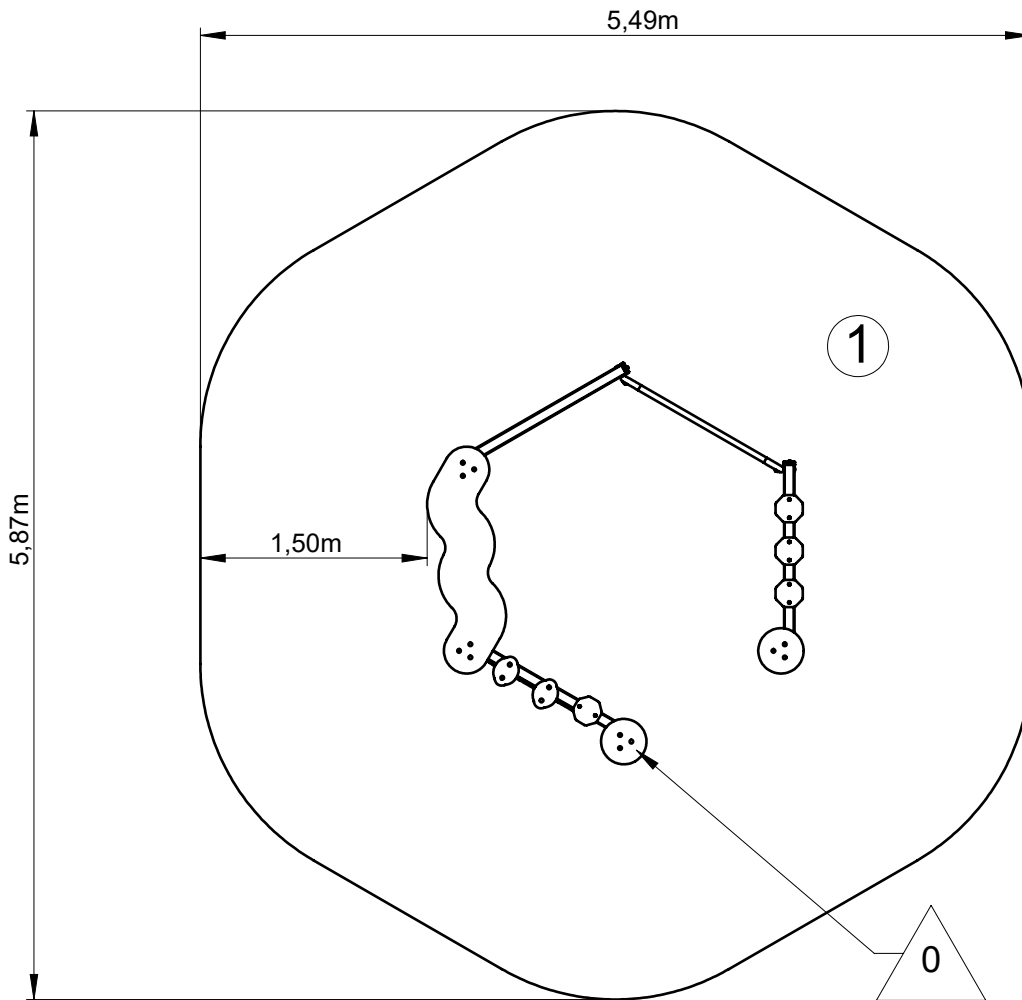

— Zone d'impact
 Impact area
 Area de impacto
 Fallraum
 Valzone

26.5 m²

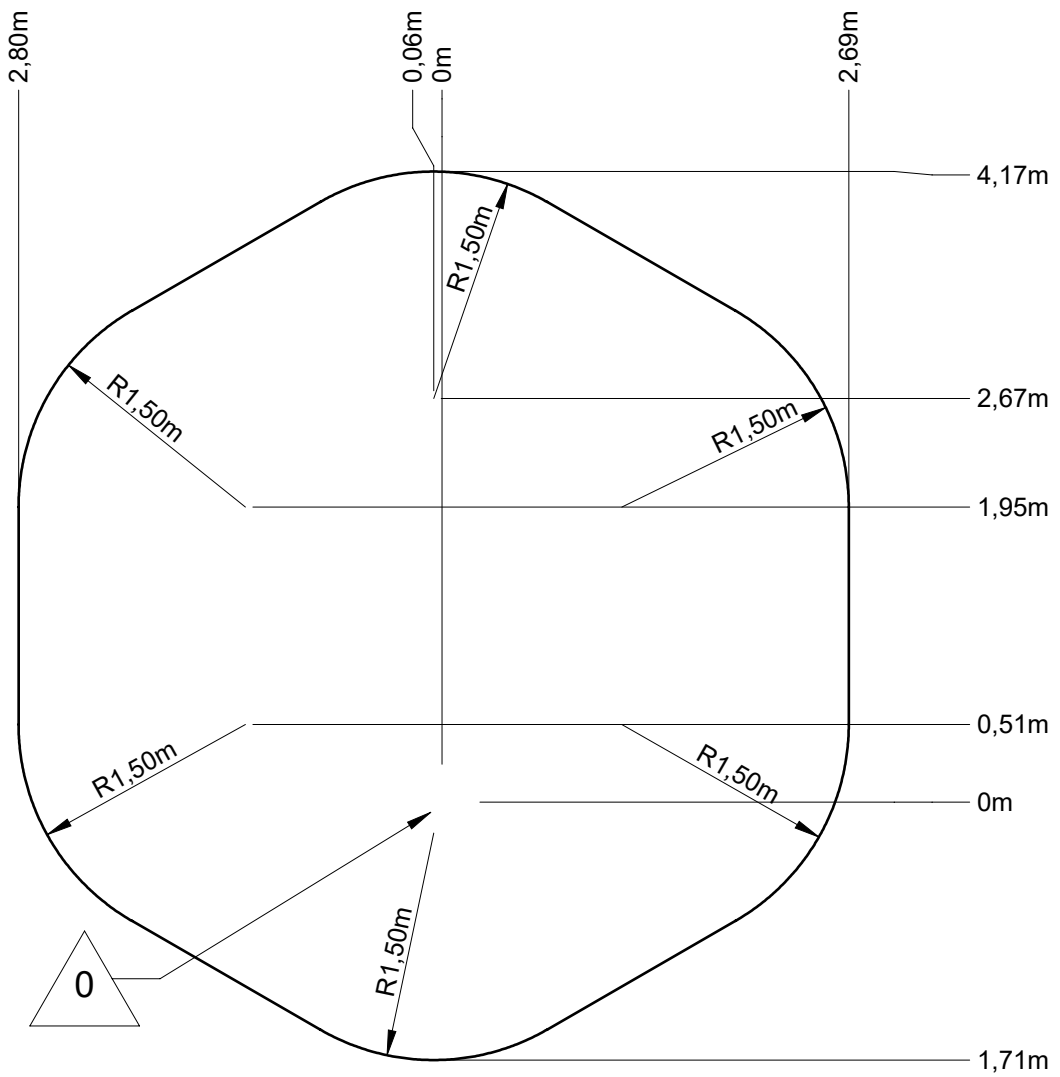

— Sol souple
 Wetpour
 Caucho continuo
 Synthetischer fallschutz
 Gietvloer

26.5 m²

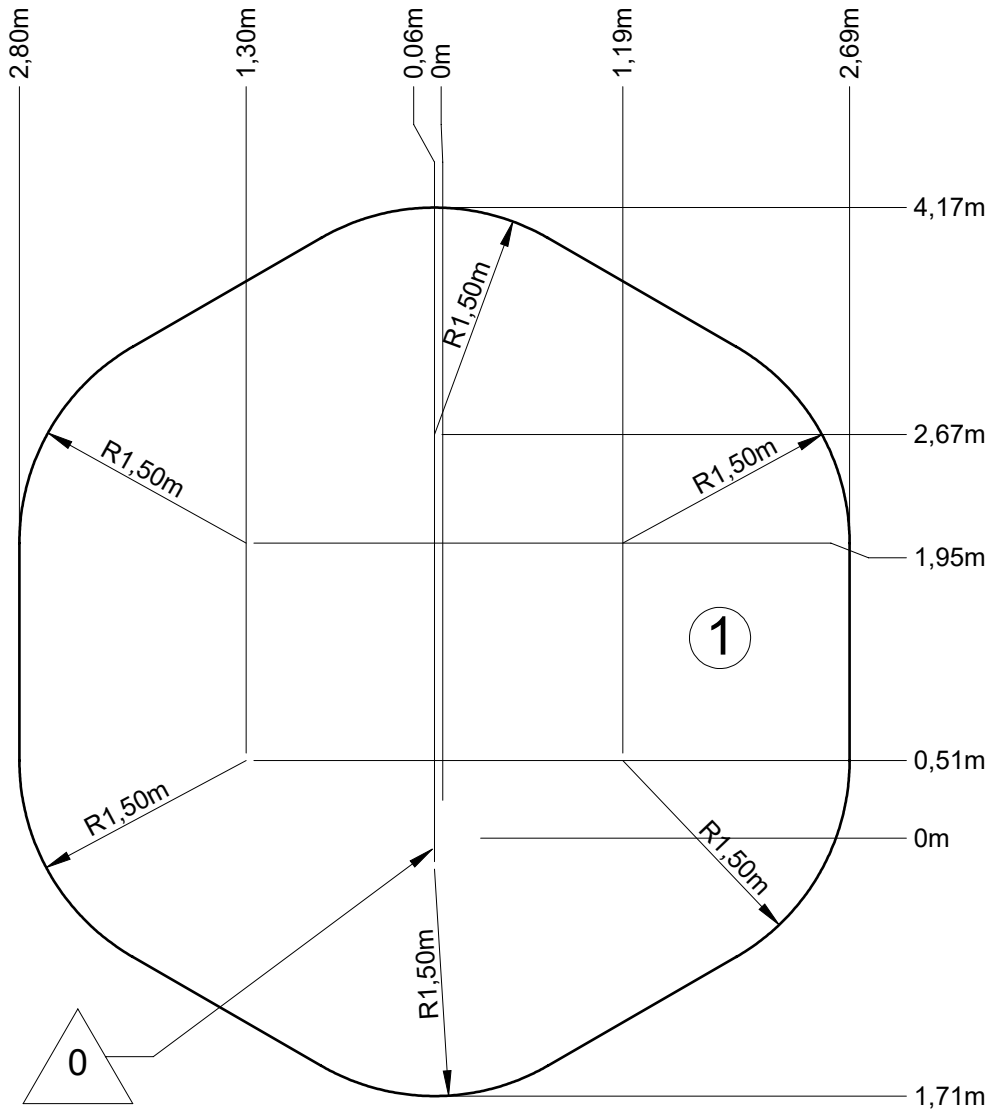

— Dalle béton
Concrete pad
Solera de hormigon
Beton bodenplatte
Betonnen bodemplaat

20 m
26.5 m²

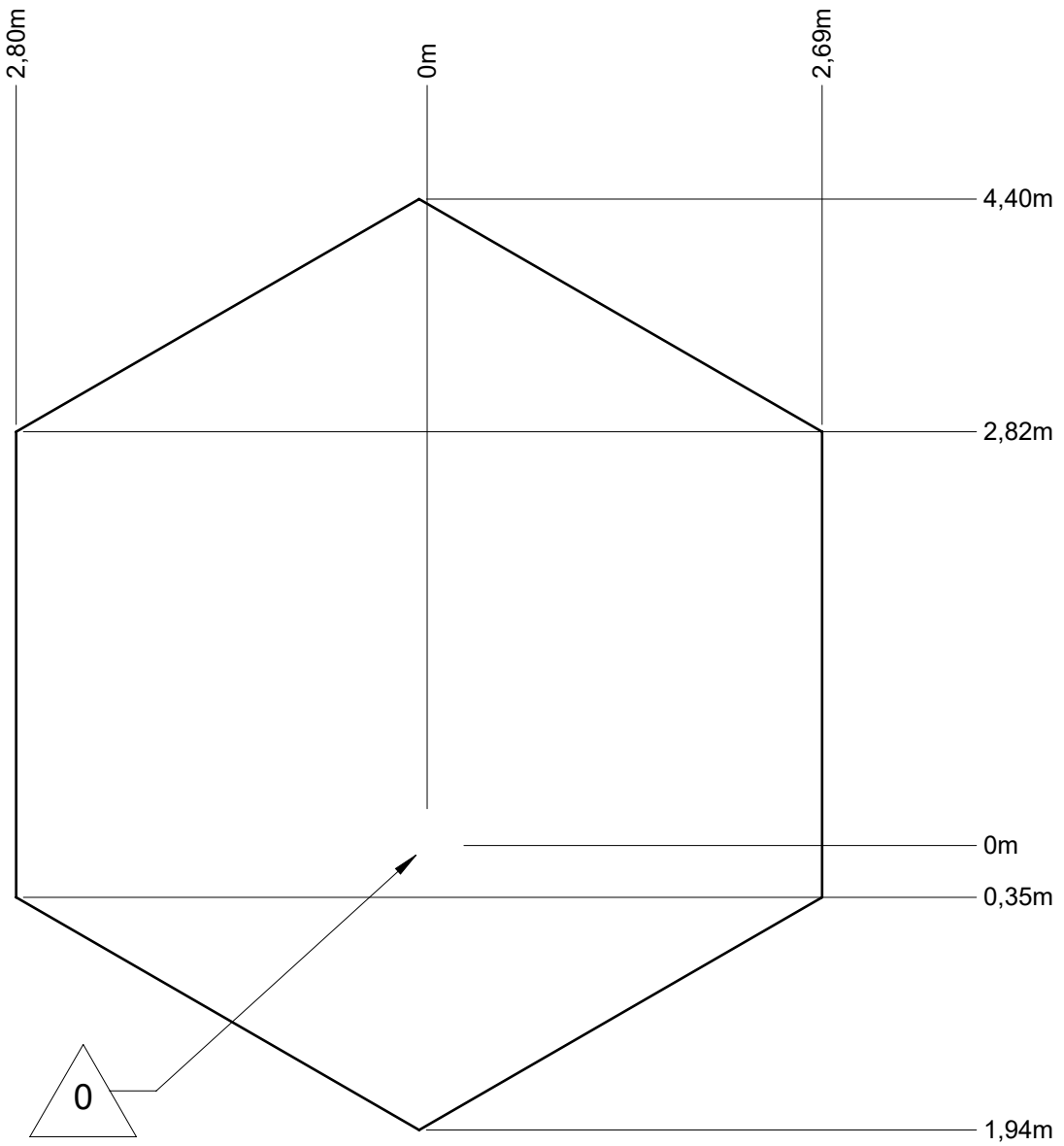

— Sol fluent
Loos partucule material 28 m
Arenero
Loses Bodenmaterial 35 m²
Los bodemmaterial

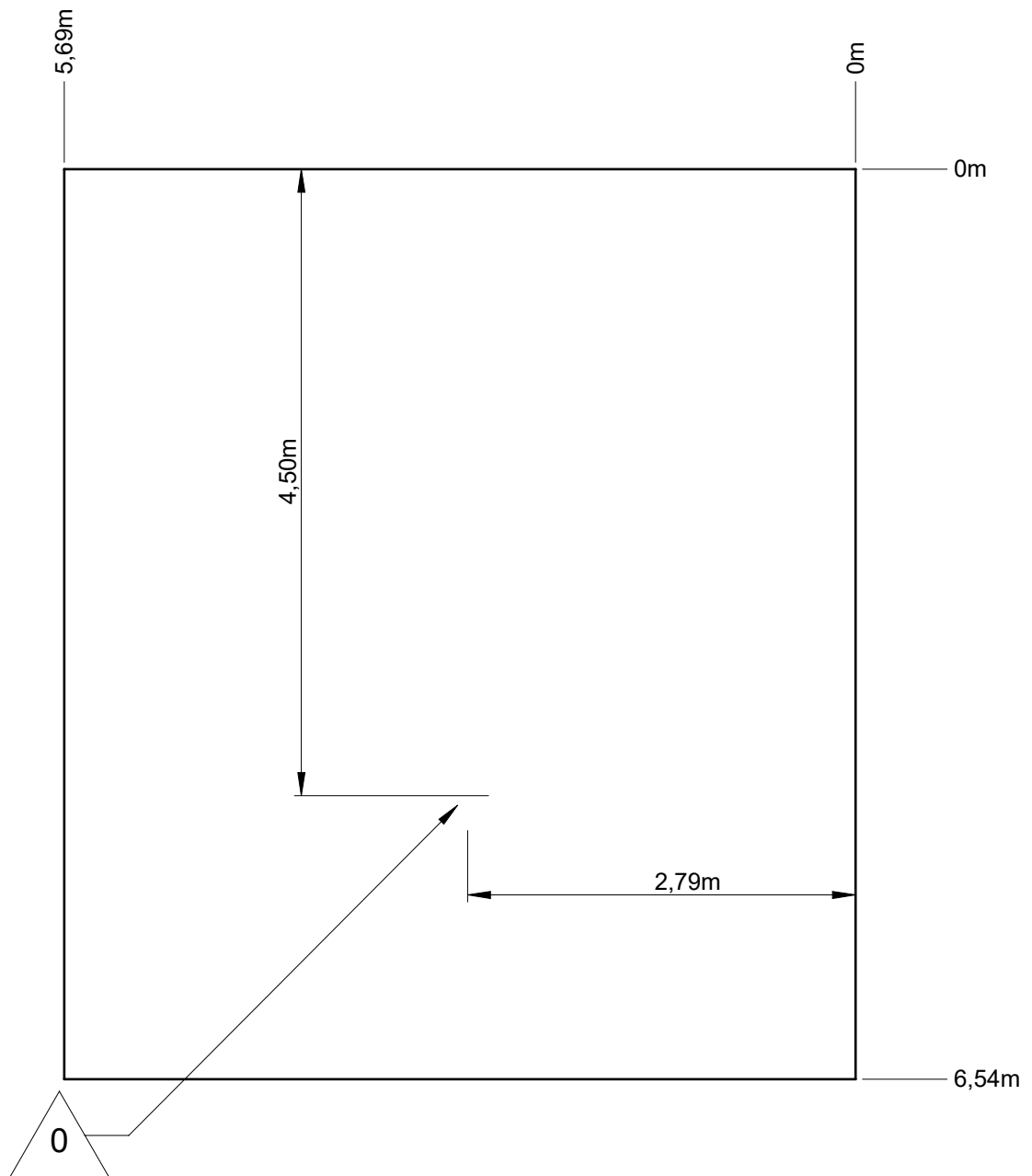

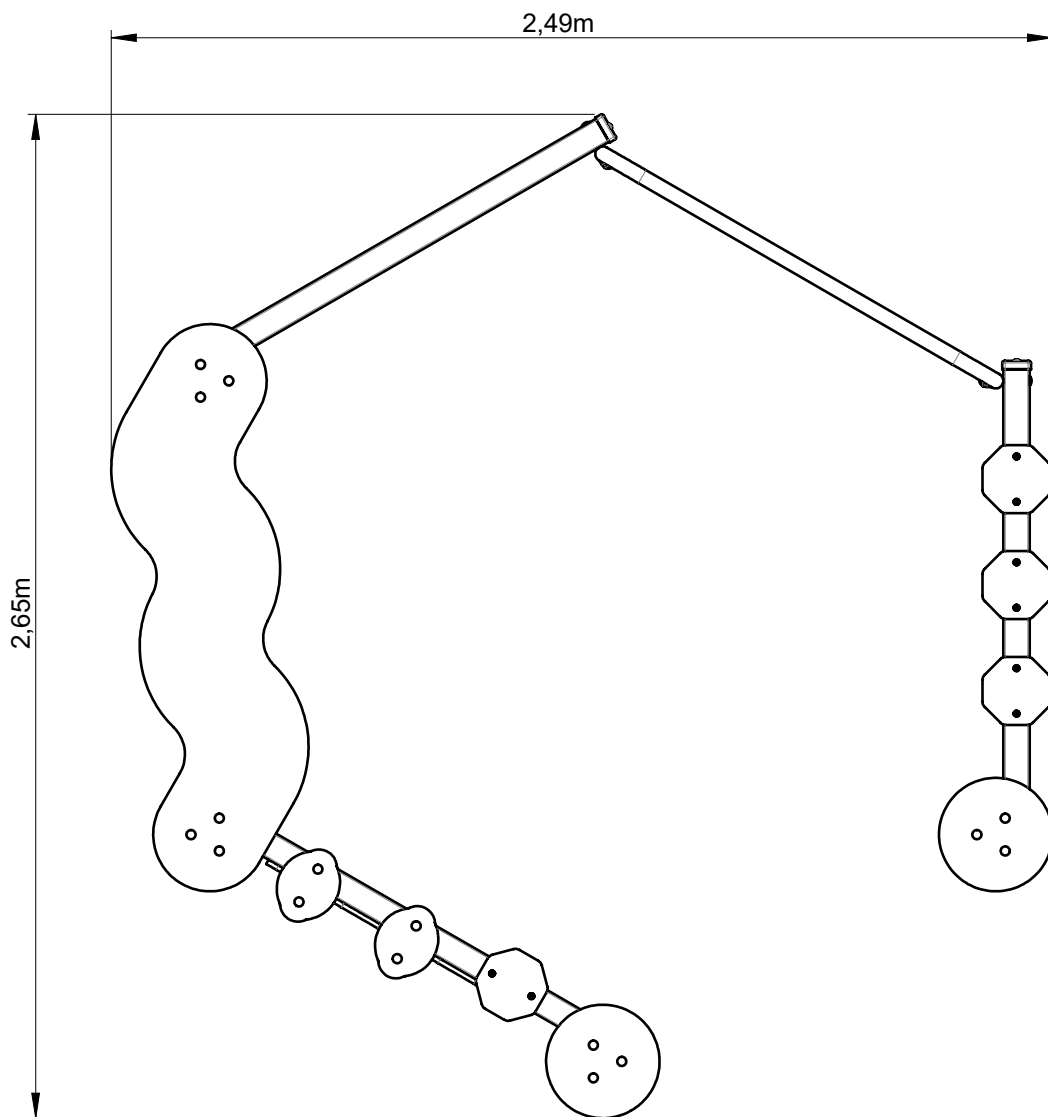
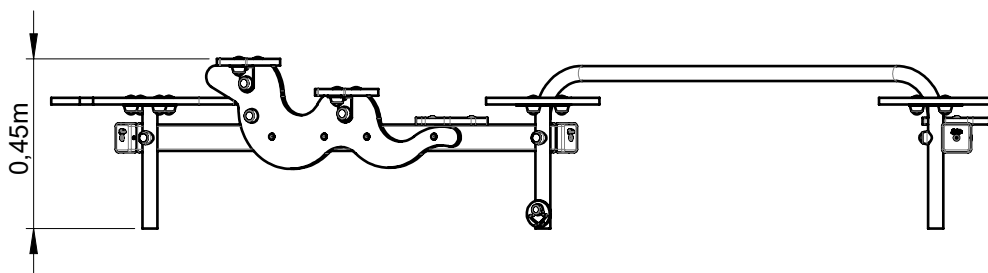



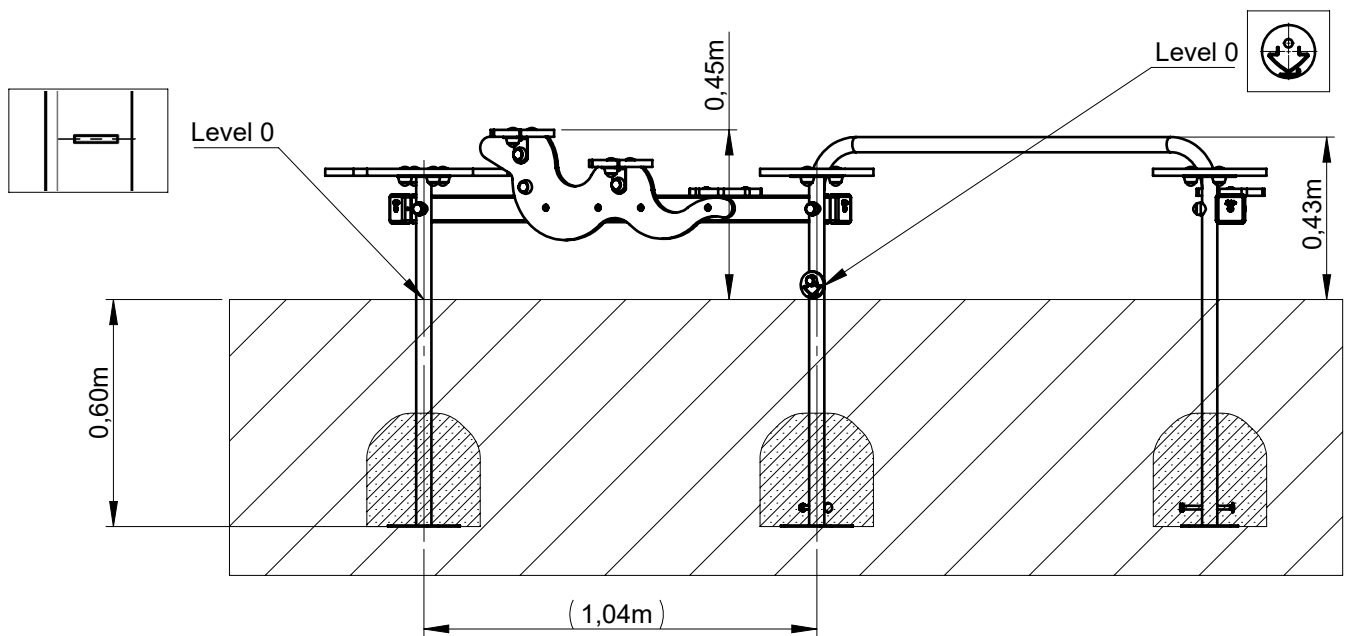
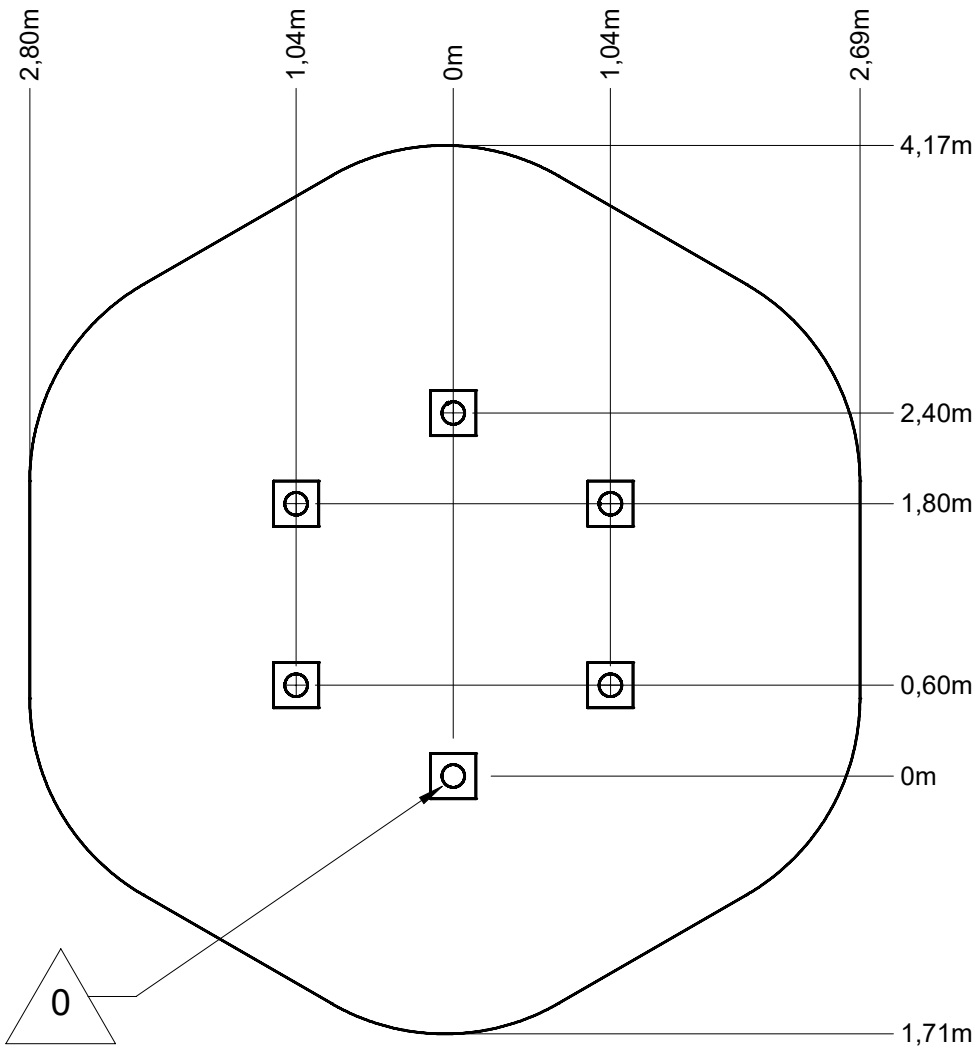

Implantation
 Footing plan
 Implantación
 Fundamentplan
 Funderingstekening

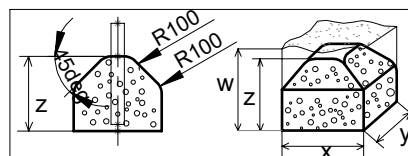

 x2
 2H
 0.2 m³



	x	y	z	w
	0.3	0.3	0.3	0.6
	0.4	0.4	0.3	0.6
	0.6	0.3	0.3	0.6

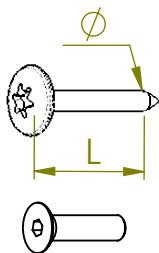

VBT 6 x 30
 \varnothing \uparrow L (mm)

VFHC



VEC M10
 \varnothing



VEF



VEB

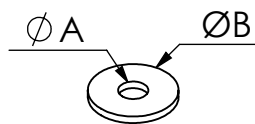

VR6x18
 $\varnothing A$ $\varnothing B$

VTHA

< 14 N.m

Couple de rupture
Breakage torque

1000 - 1800 RPM

Vitesse de rotation
Rotation speed

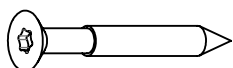

VWT

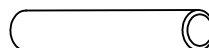

VGC

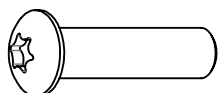

VCBHC

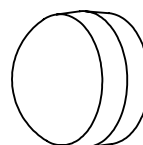

M10 440N

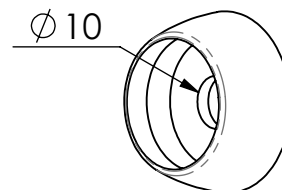

M10 310 N

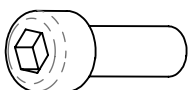

VBTR

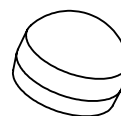

M8 440N

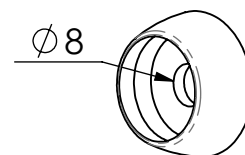

M8 310N

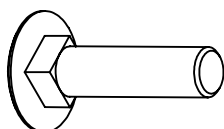

VTRCC

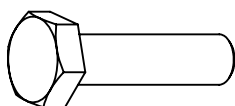

VTH

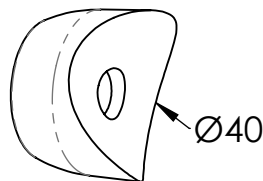

MI2503

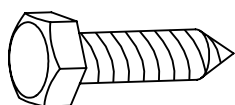

VTF

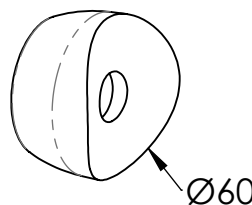

MI2701

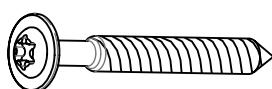

VBT

1 x2

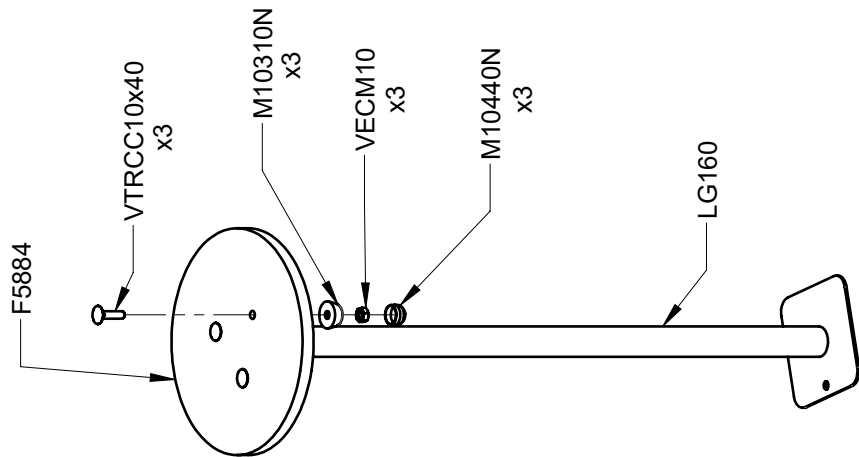

2

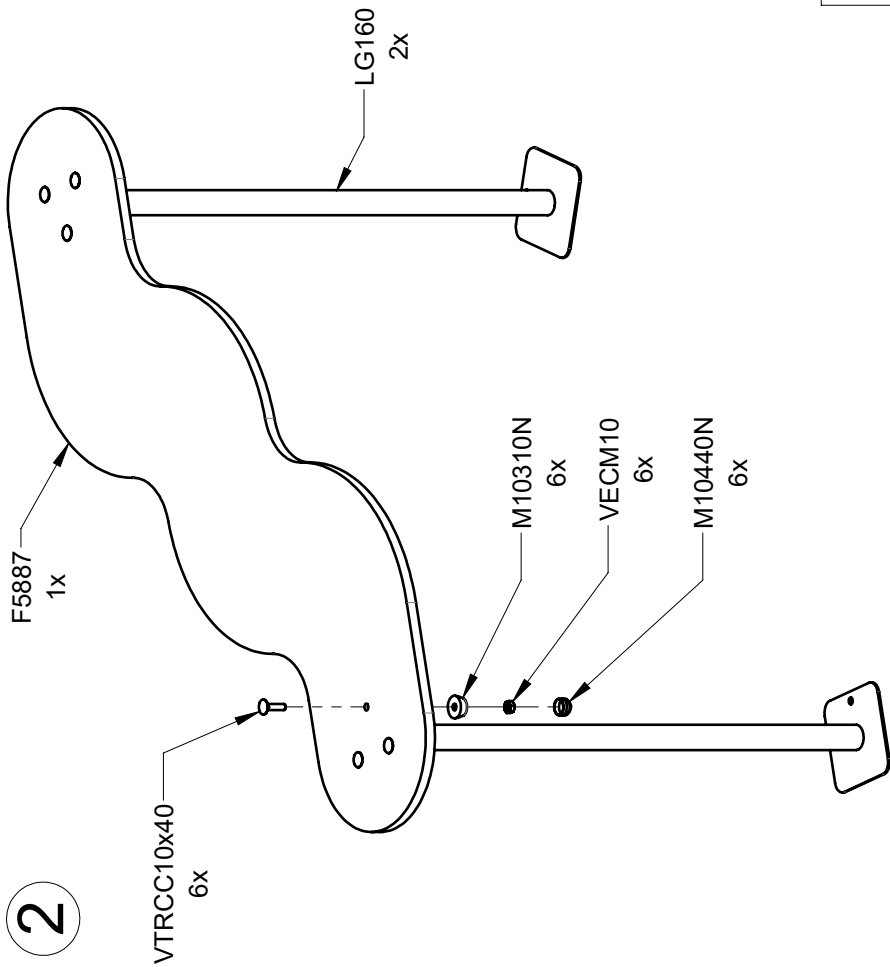

3 x3

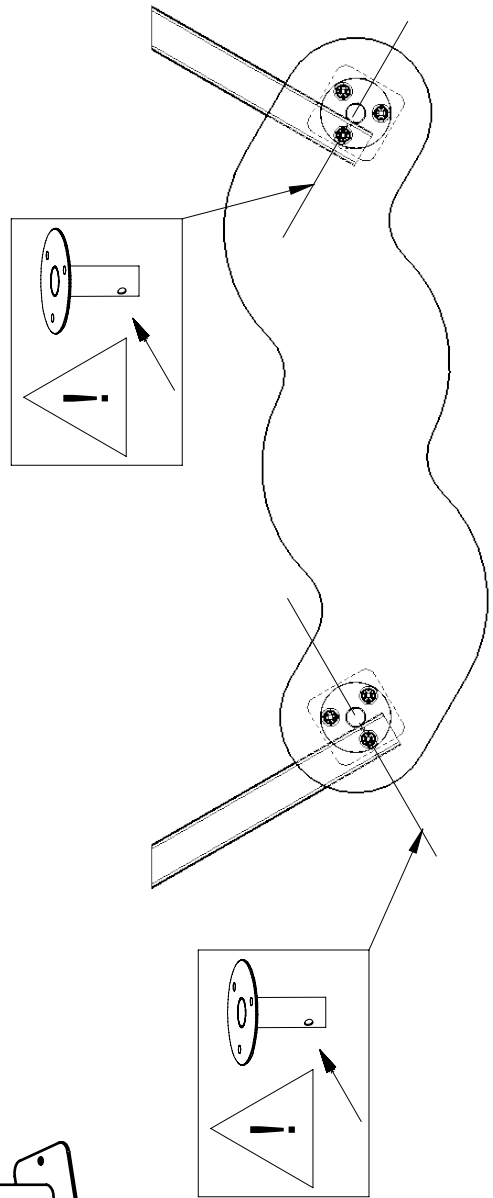
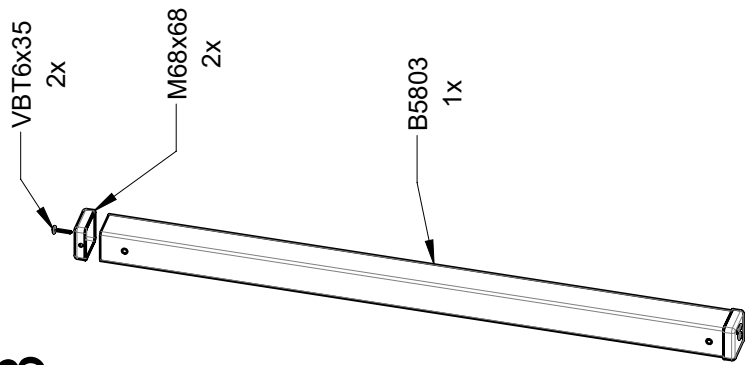

4

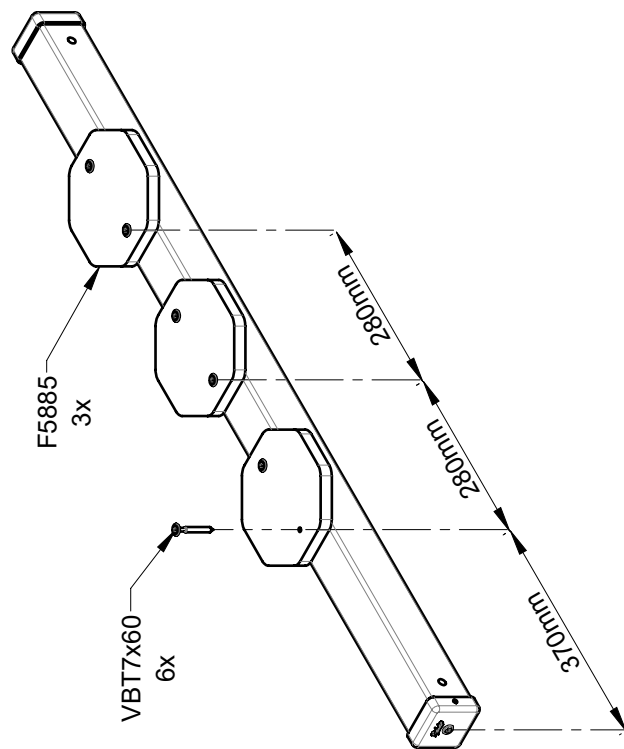

5

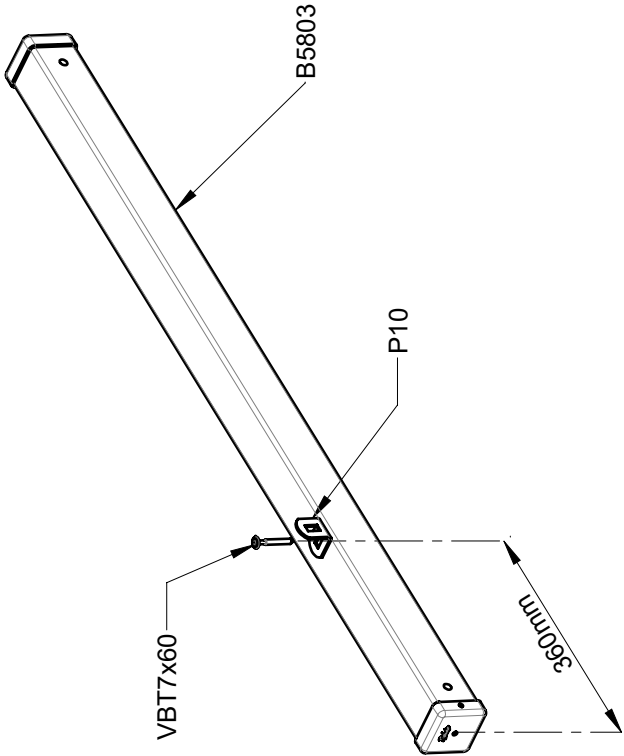

6

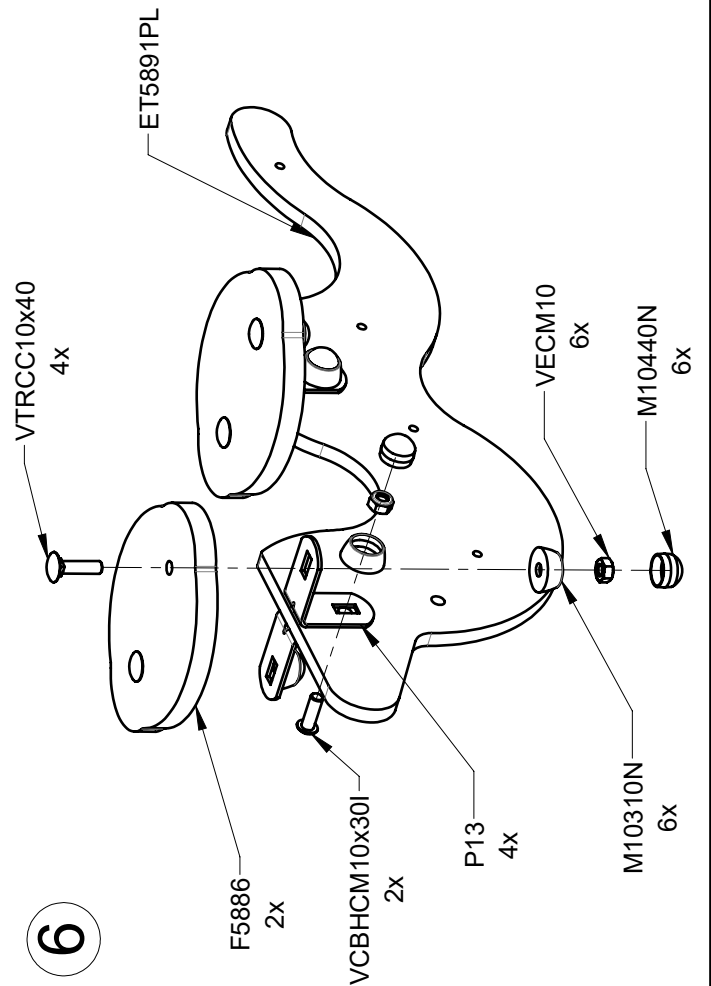

7

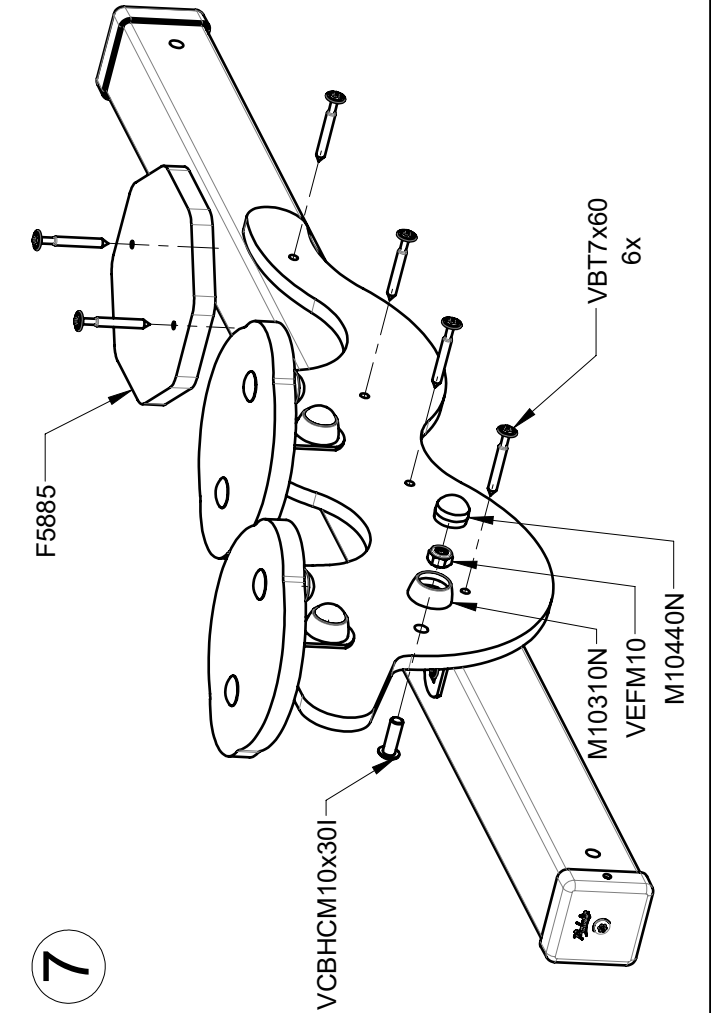

9

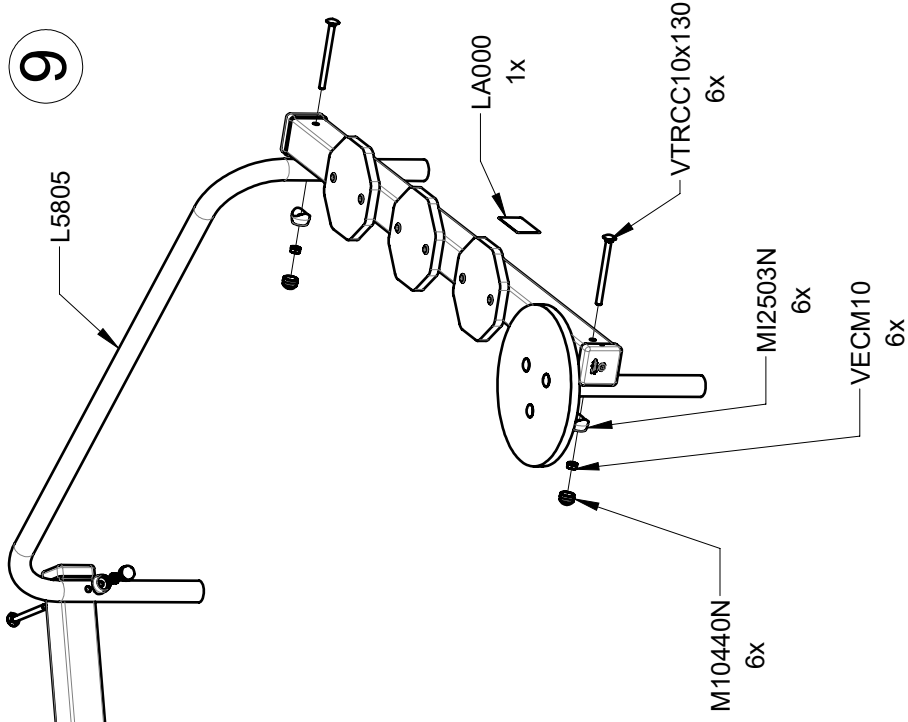

8

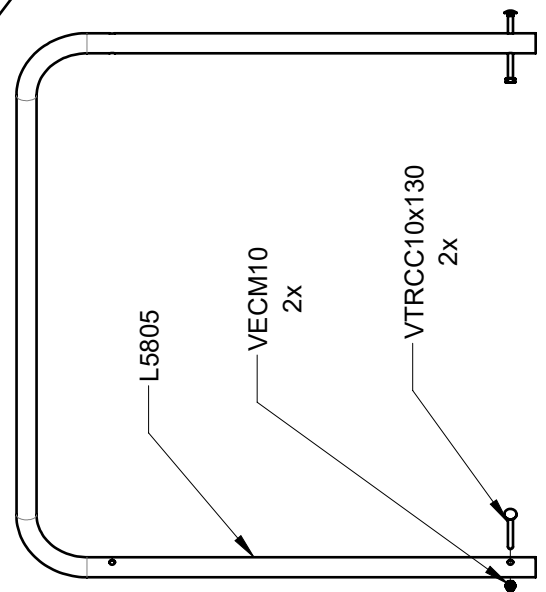

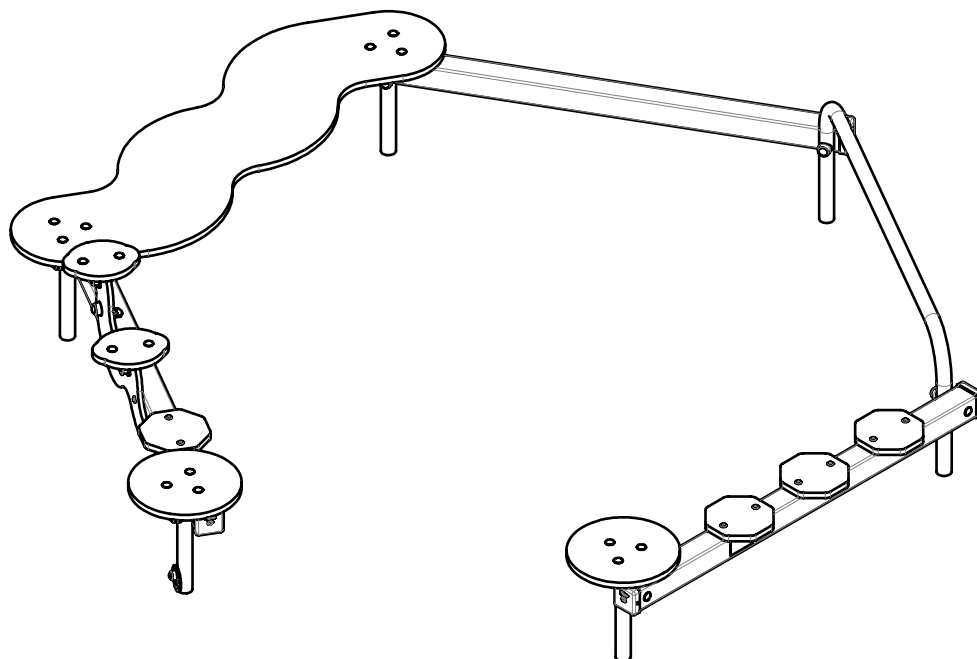

Réf	Qté
B5803	3
ET5891PL	1
F5884	2
F5885	4
F5886	2
F5887	1
L5805	1
LA000	1
LG160	4
M68x68	6
M8310N	1
M8440N	1
M10310N	19
M10440N	25
MI0002	1
MI2503N	6
P10	1
P13	4
VBT6x35	6
VBT7x60	13
VCBHCM10x30I	3
VECM10	24
VEFM10	3
VTH6x30A	1
VTRCC10x40	16
VTRCC10x130	8