

J5805

Pro ludic

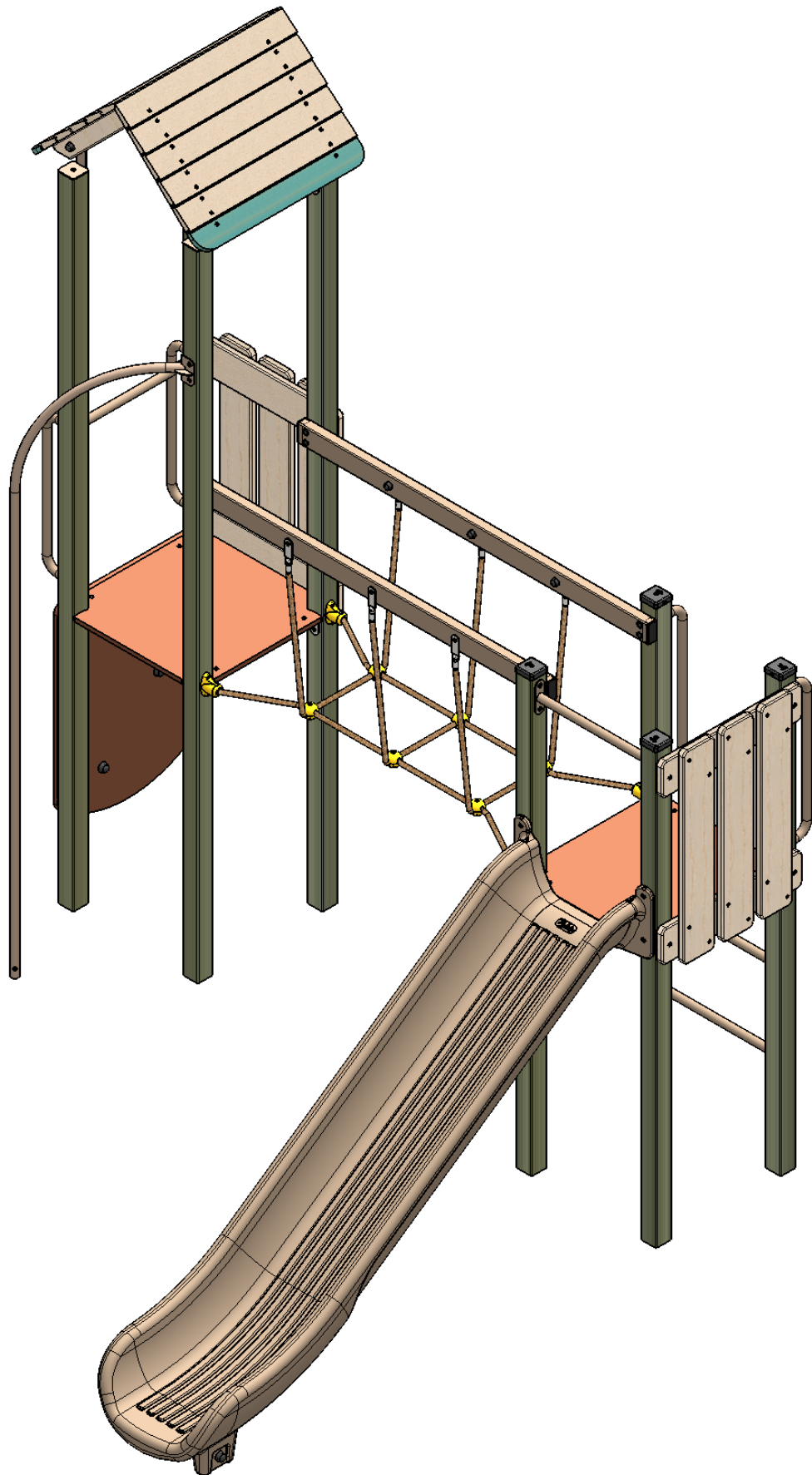

4x
B5800



4x
B5801

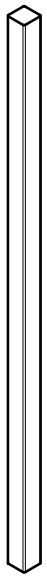

4x
L5803

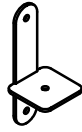

1x
U5801

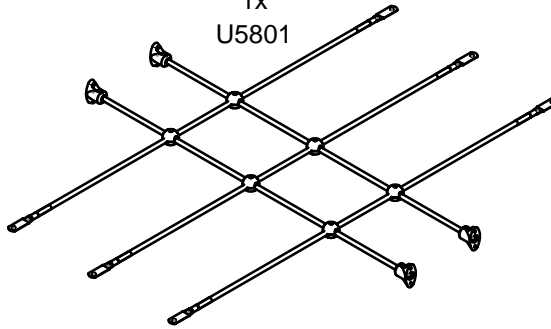

2x
U5804

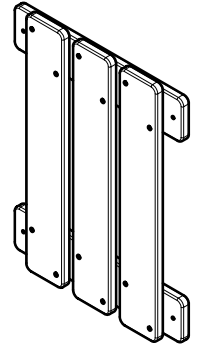

2x
L5802

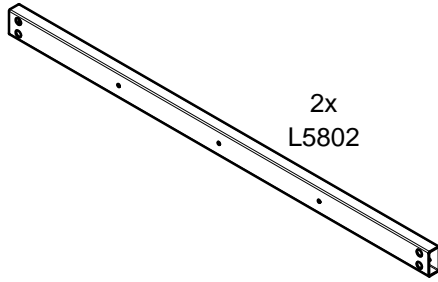

2x
U5805

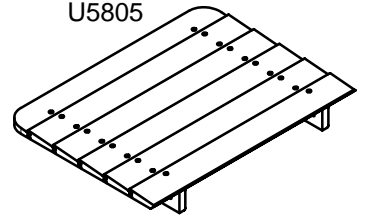

1x
LG5803

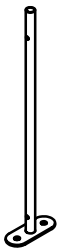

2x
LG08

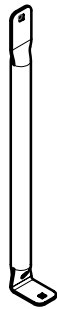

4x
L5800

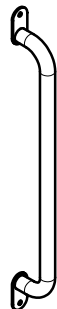

8x
LG5800

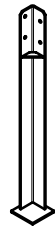

4x
L5801

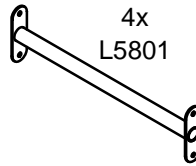

1x
L5804



2x
F5805

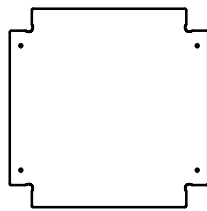

1x
M58001

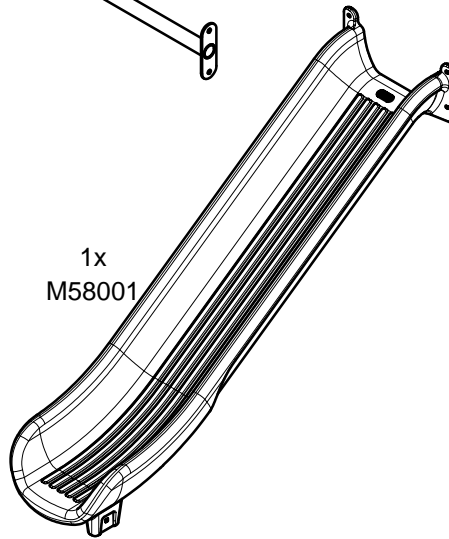

8x
P30

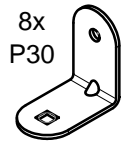

1x
F5808

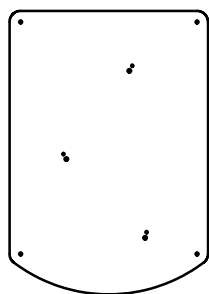

8x
M2200



4x
M68x68

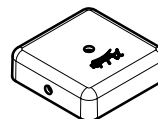

4x
M4080

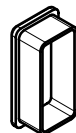

3x
MI3800



LA000	1
M10310N	5
M10440N	8
M8310N	25
M8440N	25
MI0002	1
VBT6*35	8
VBT7*60	109
VCBHCM10*20I	2
VCBHCM8*30I	8
VCBHCM8*40I	1
VCBHCM8*60I	12
VEFM10	3
VEFM8	21
VTRCC10*70	3



N°		
1	1 m	6 m ²
2	1.17 m	15.5 m ²
3	1.4 m	6.5 m ²

— Zone d'impact
Impact area
Area de impacto
Fallraum
Valzone



Point de référence
Setting out point
Punto de referencia
Bezugspunkt
Referentiepunt

- - - Espace libre
Free space
Espacio libre
Freiraum
Vrije ruimte

EN1176-1:2017
EN1176-3:2017

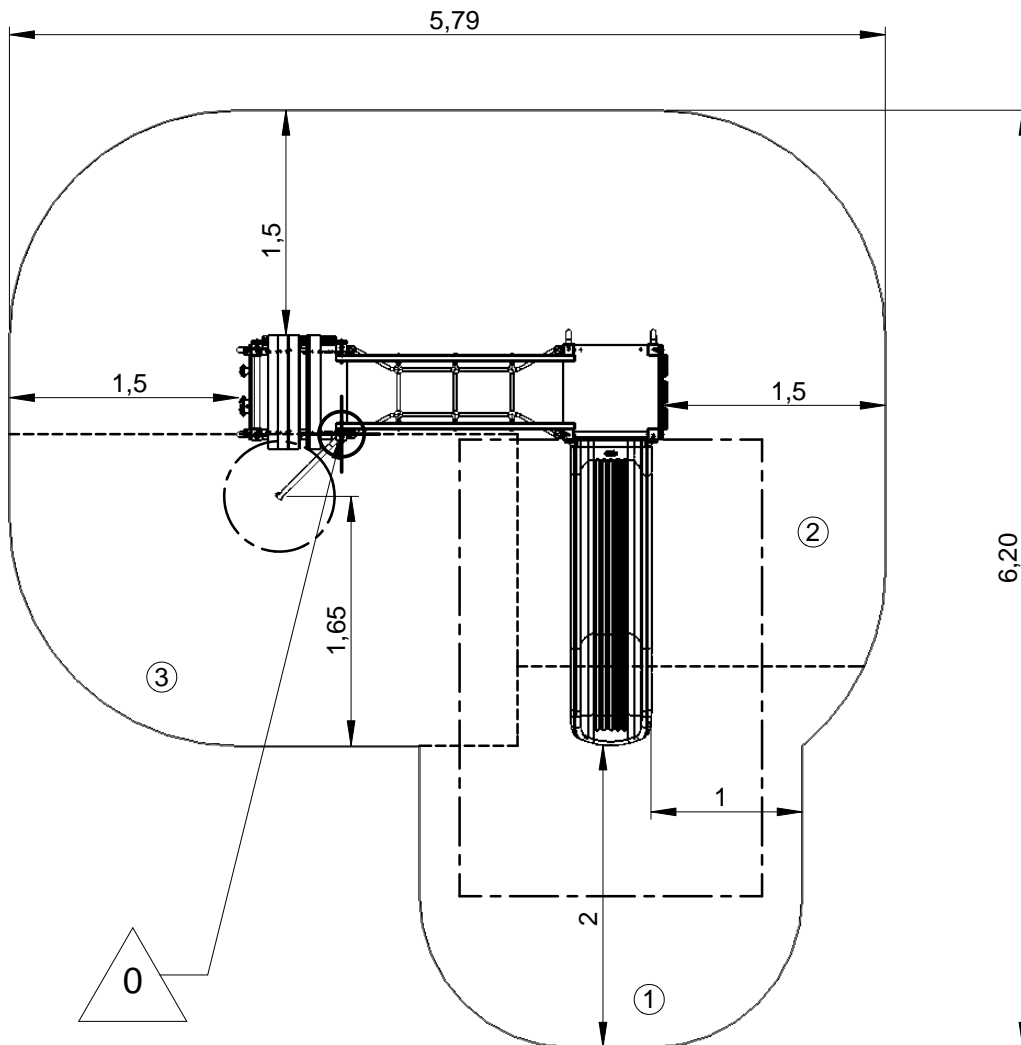

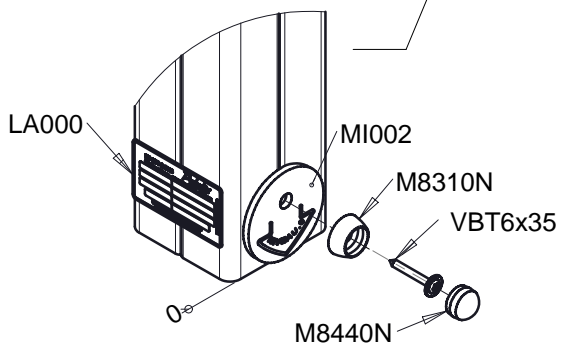
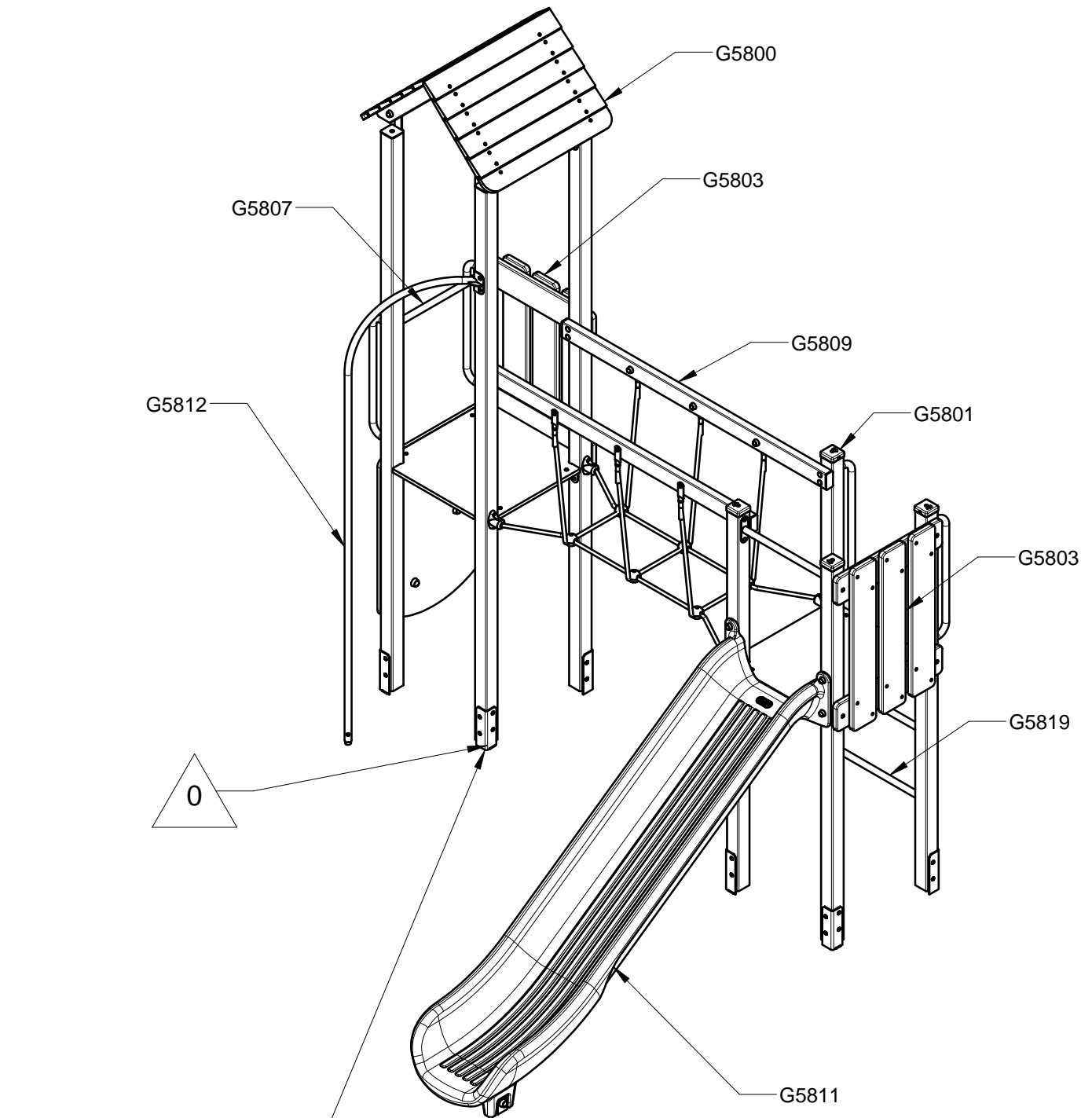

G5800	1
G5801	1
G5803	2
G5807	1
G5809	1
G5811	1
G5812	1
G5819	1

— Zone d'impact
 Impact area
 Area de impacto
 Fallraum
 Valzone

28 m²

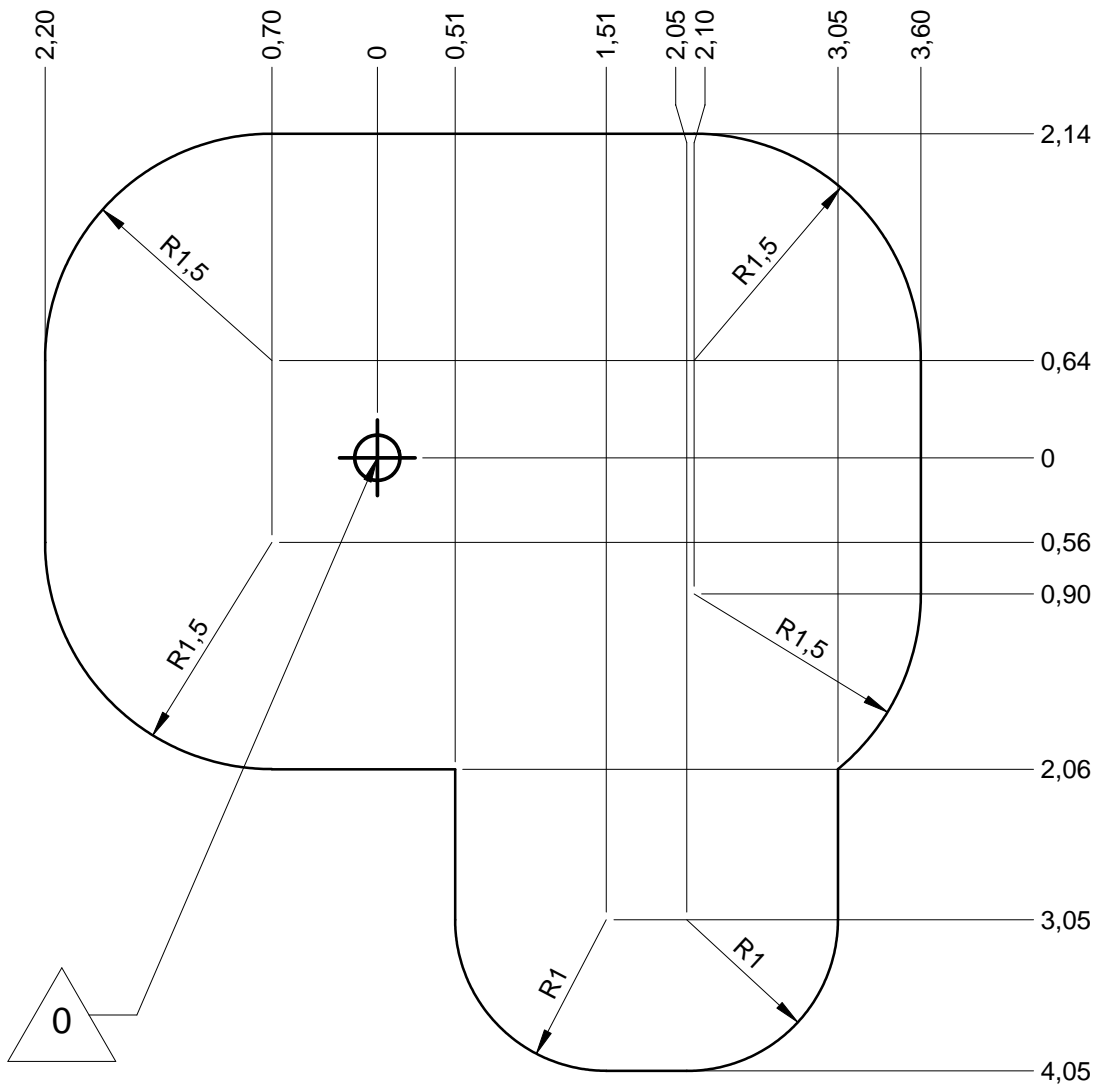

— Sol souple
 Wetpour
 Caucho continuo
 Synthetischer Fallschutz
 Gietvloer

28 m²

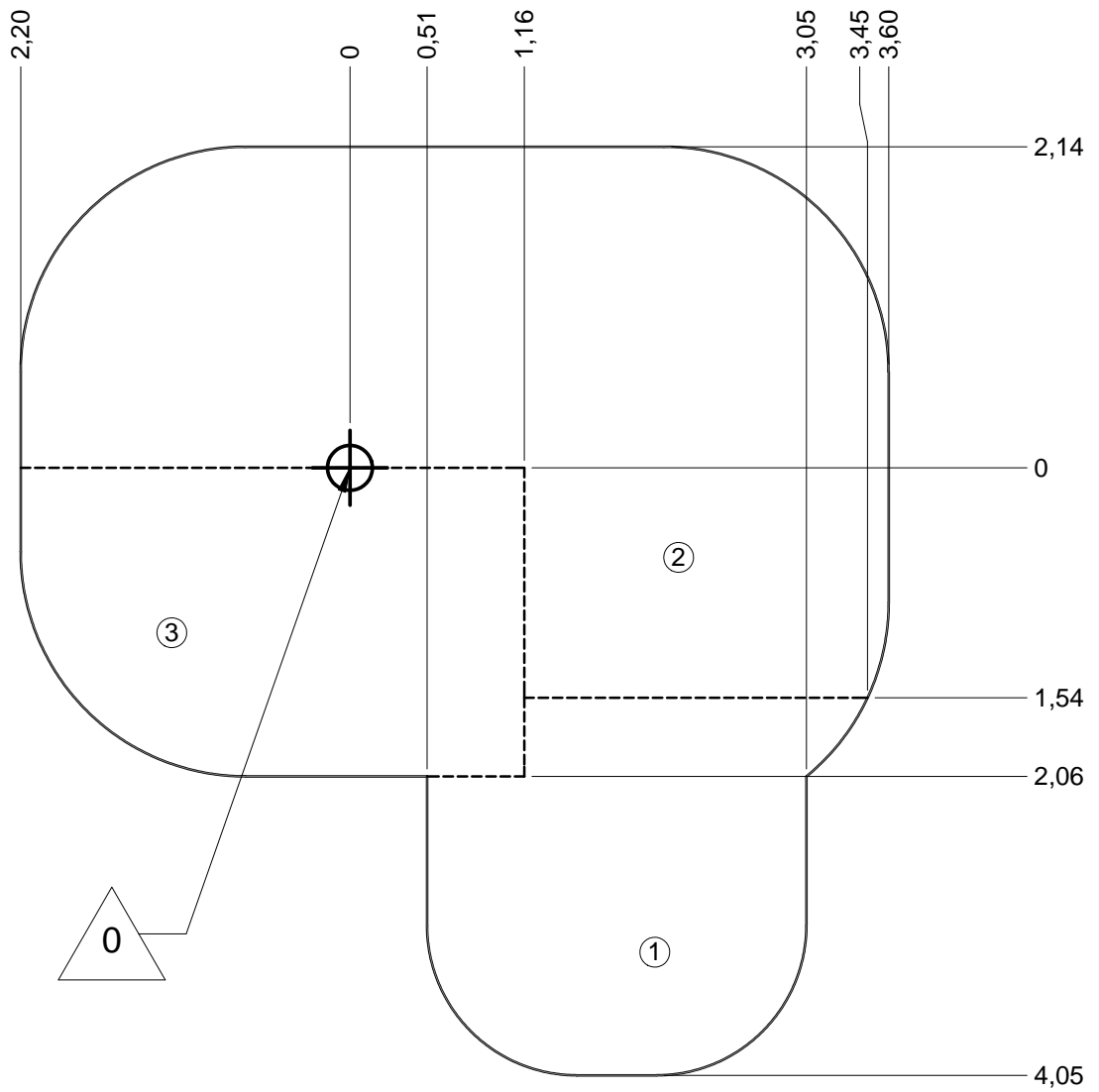

— Dalle béton
Concrete pad
Solera de hormigon
Beton Bodenplatte
Betonnen bodemplaat

24 m
30 m²

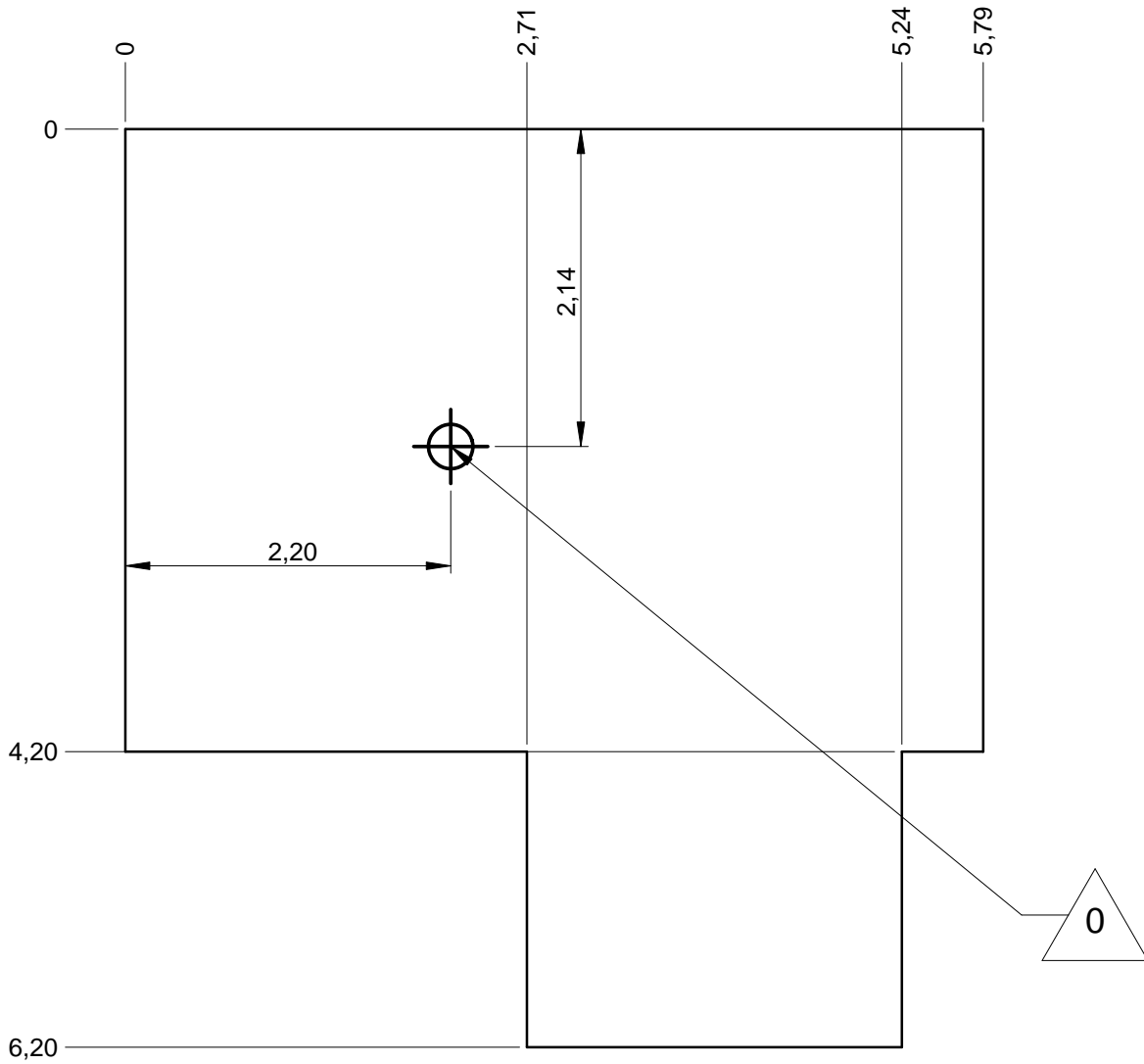

— Sol fluent
Loos partucule material 26 m
Arenero
Loses Bodenmaterial 33 m²
Los bodemmateriaal

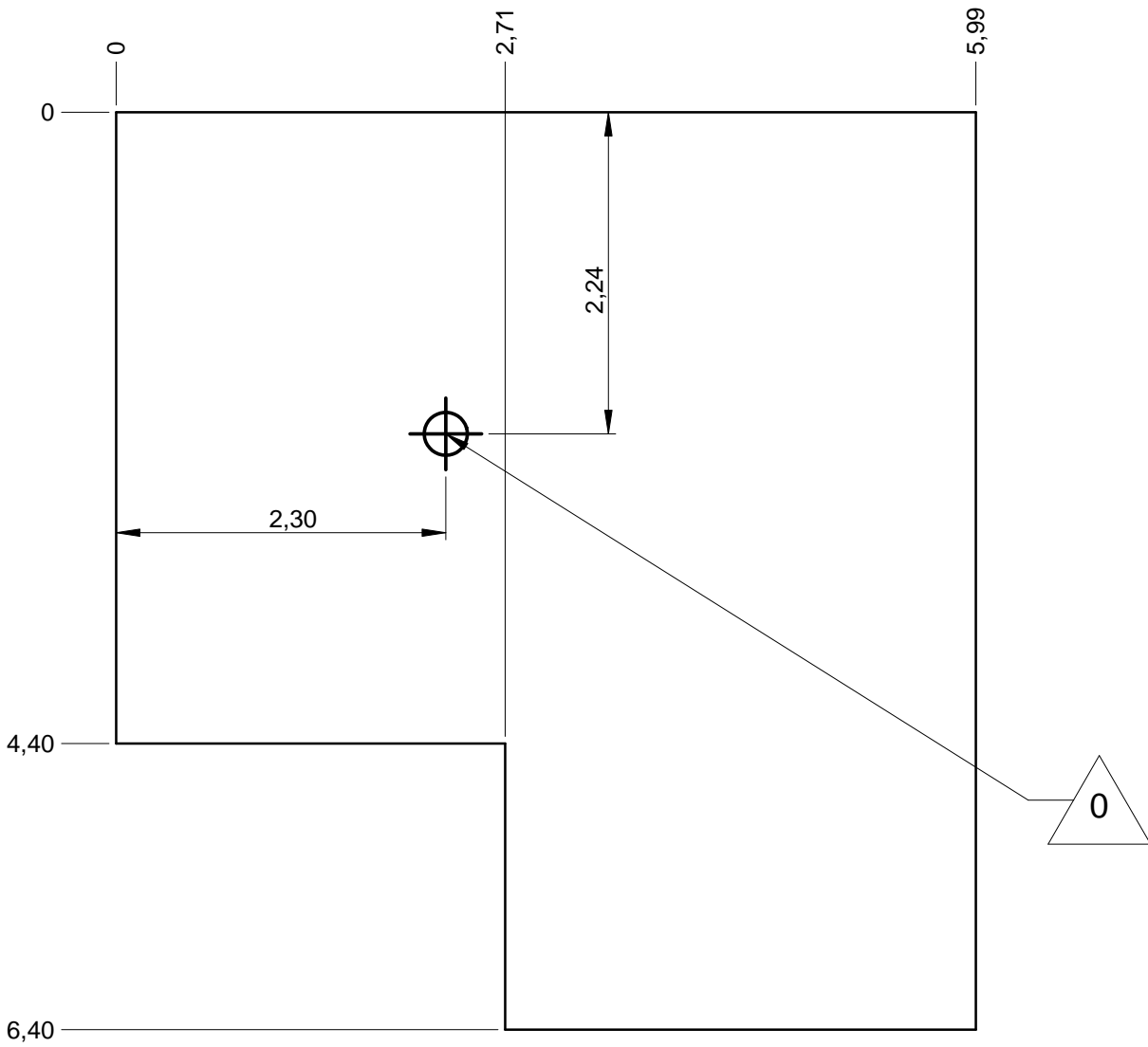

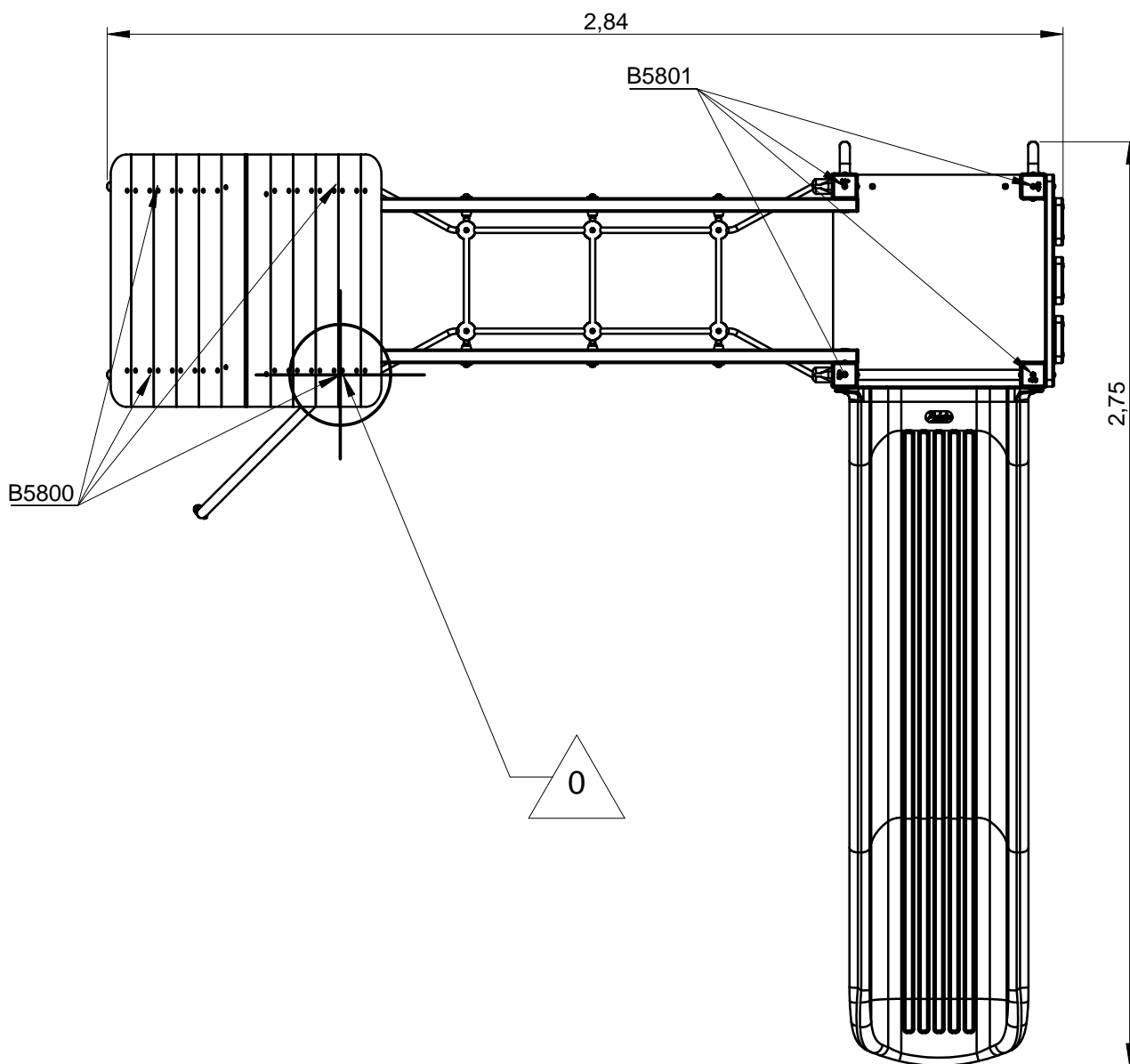

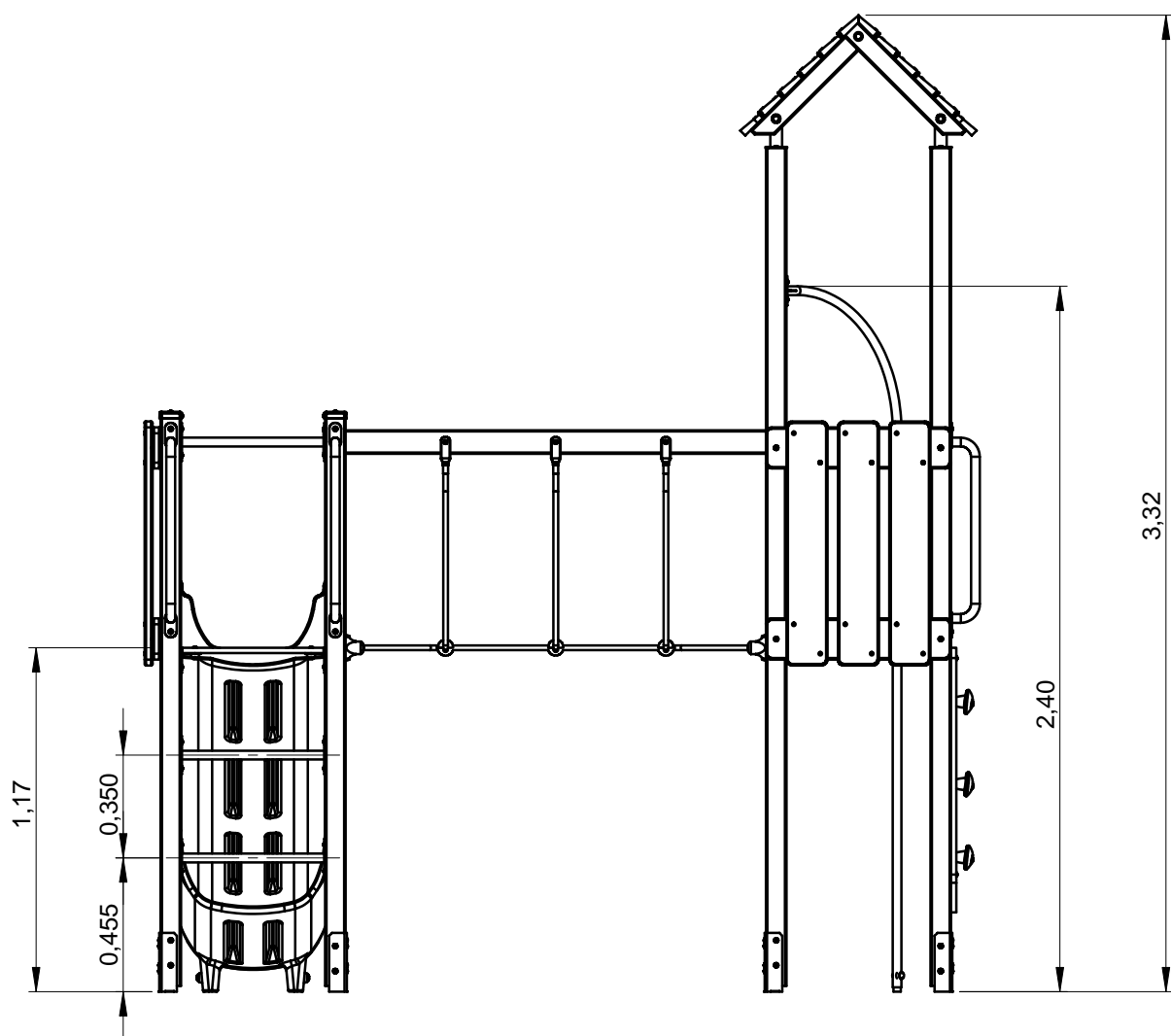

J5805A

ProLudic

Implantation
 Footing plan
 Implantación
 Fundamentplan
 Funderingstekening

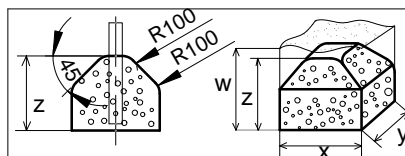
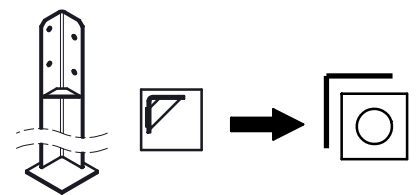
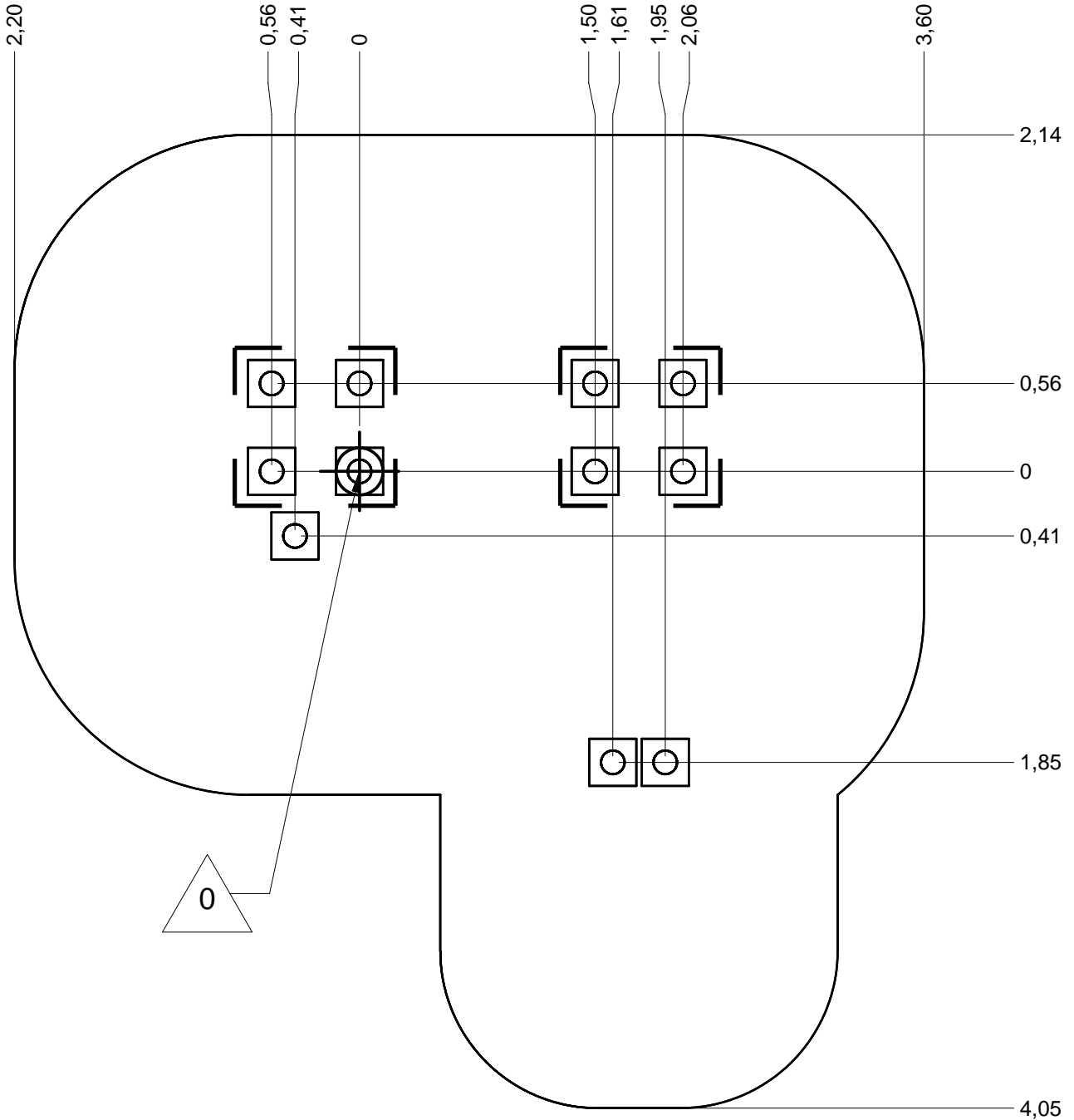

	x	y	z	w
	0.3	0.3	0.3	0.6
	0.4	0.4	0.3	0.6
	0.6	0.3	0.3	0.6



x2
 8H
 0.3 m³

J5805B

ProLudic

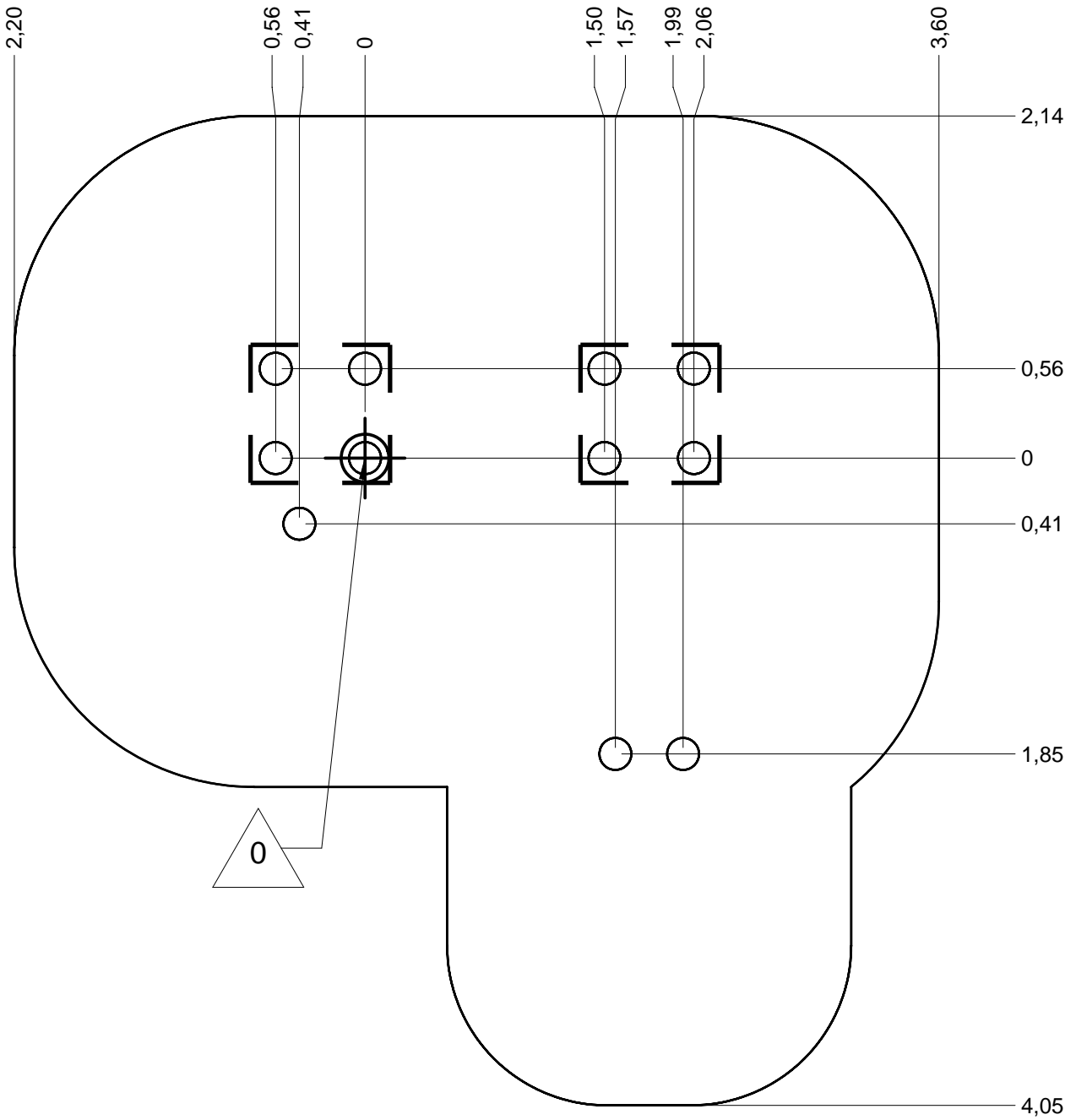
Implantation
Footing plan
Implantación
Fundamentplan
Funderingstekening



 x2	 8H	 RD14M10
---	--	---

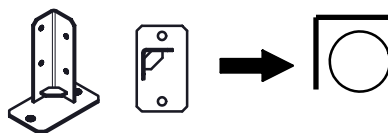

1

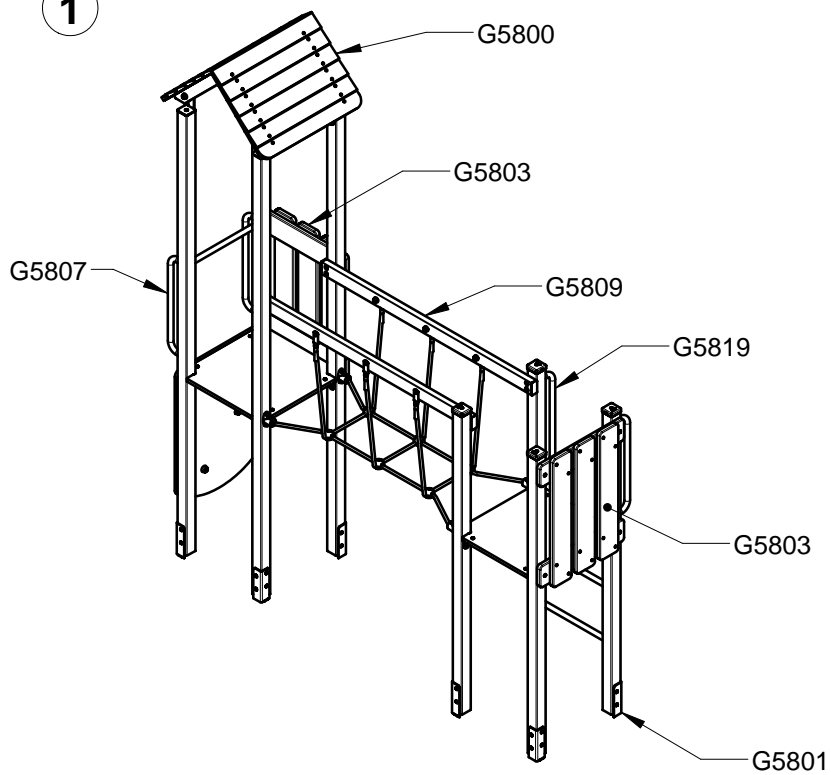

2

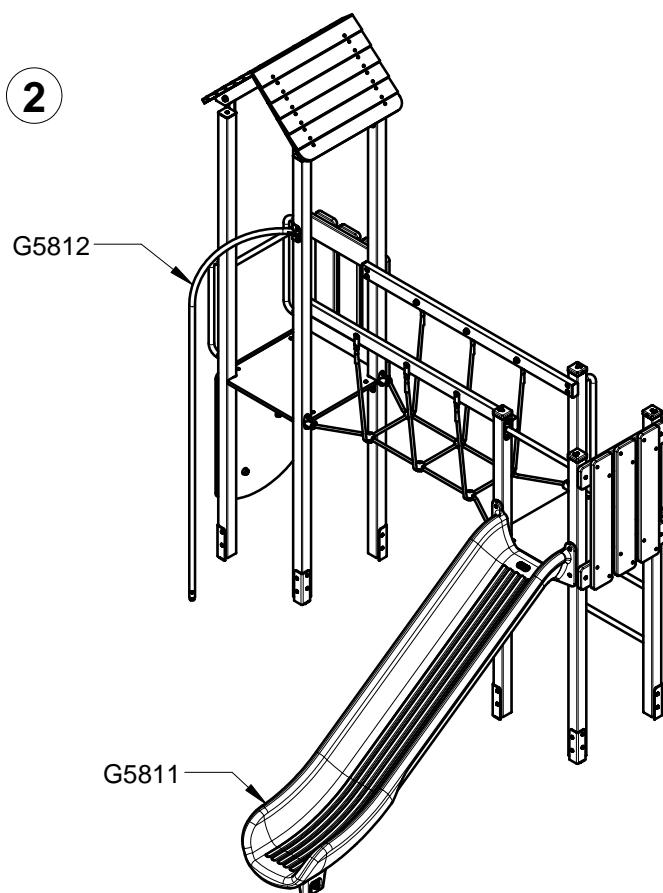

LGP.... A

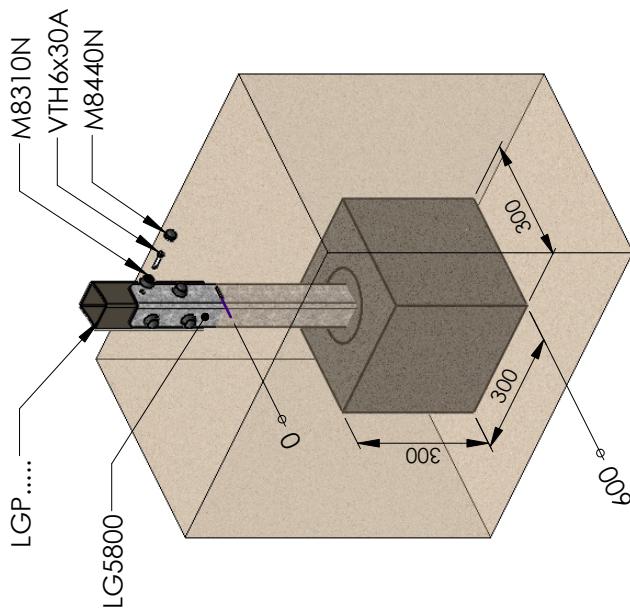

LGP.... B

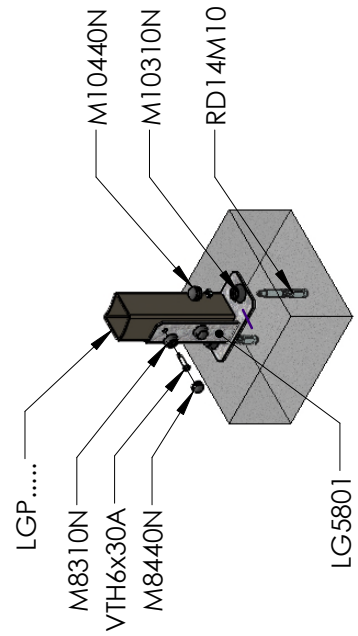

B.... A

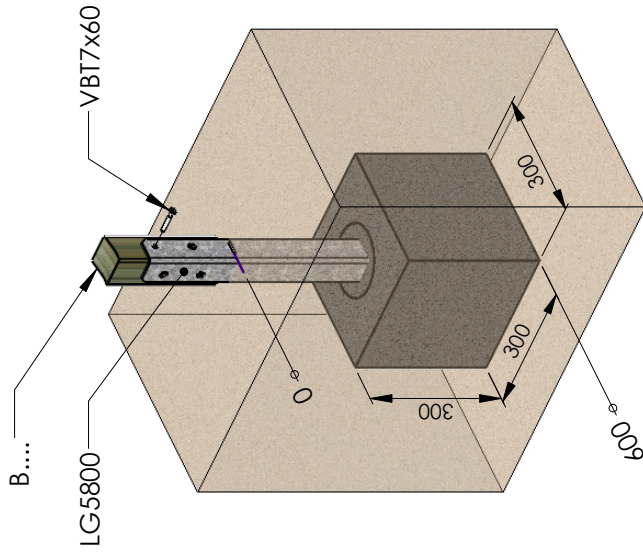

B.... B

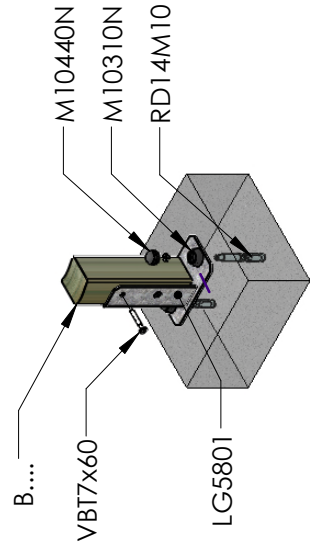

ET.... A

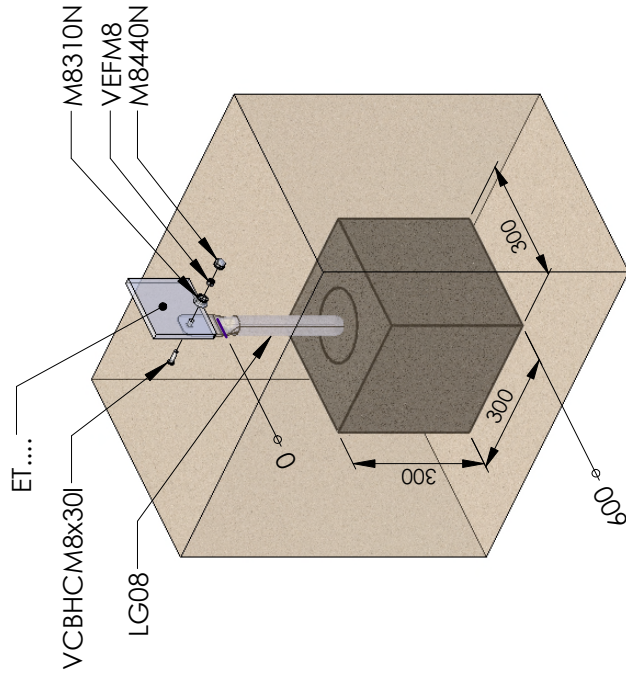

ET.... B

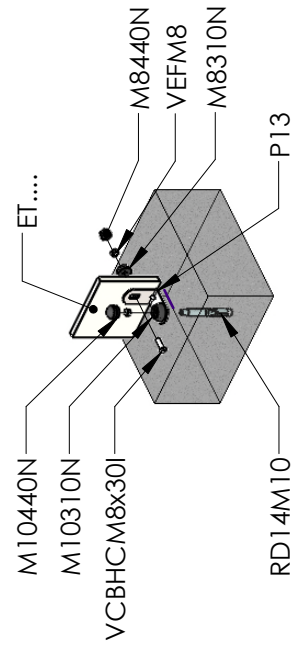

L.... A

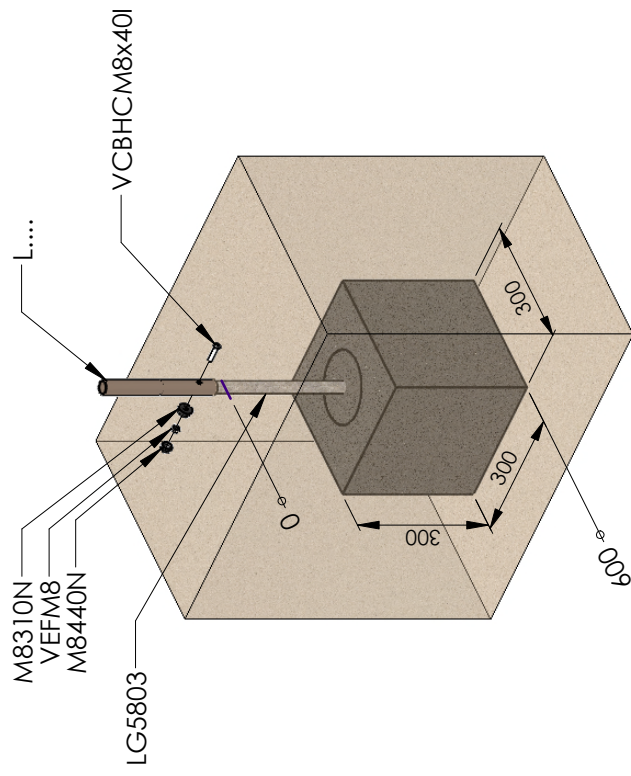

L.... B

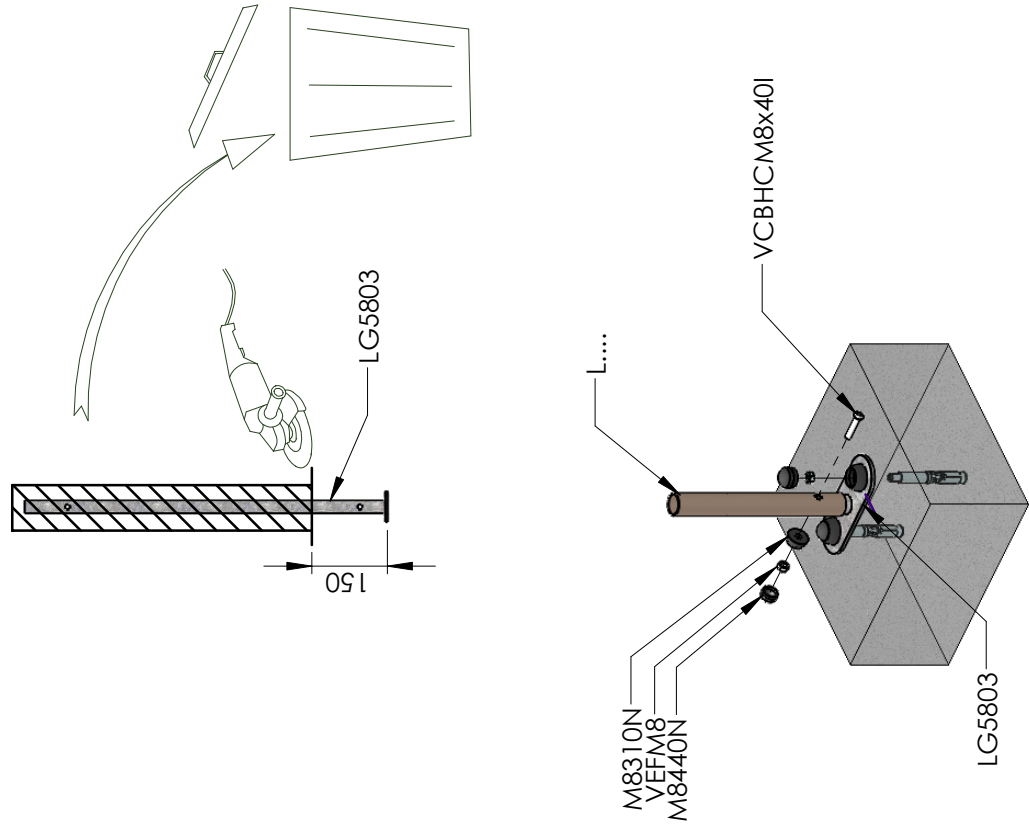

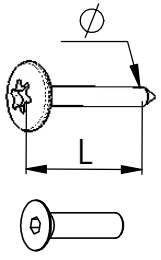

VBT 6 x 30
 \varnothing L (mm)

VFHC

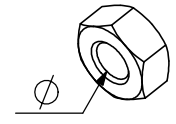

VEC M10
 \varnothing



VEF

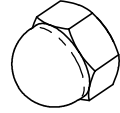

VEB

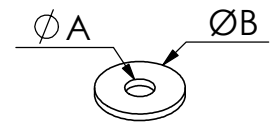

VR6x18
 $\varnothing A$ $\varnothing B$

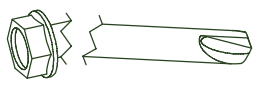

1000 - 1800 RPM
 Vitesse de rotation
 Rotation speed

< 14 N.m
 Couple de rupture
 Breakage torque

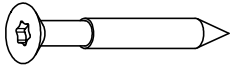

VWT

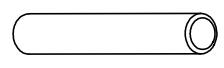

VGC

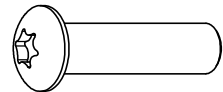

VCBHC

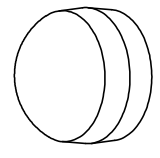

M10 440N

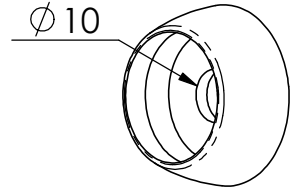

M10 310 N

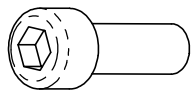

VBTR

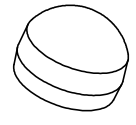

M8440N

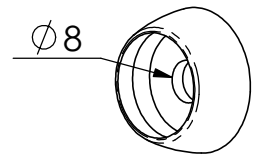

M8310N

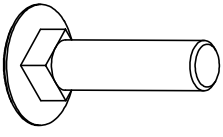

VTRCC

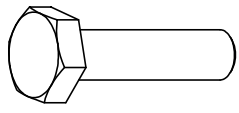

VTH

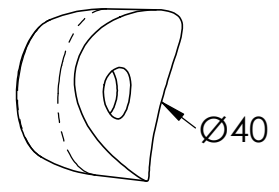

MI2503

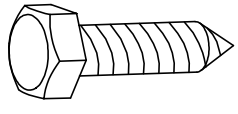

VTF

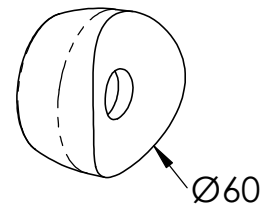

MI2701

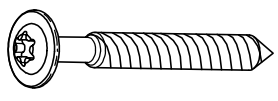

VBT

1

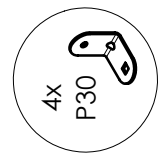
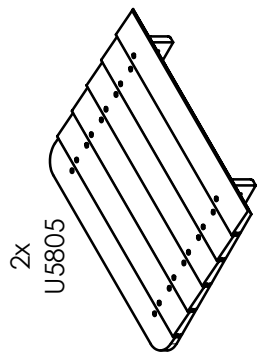
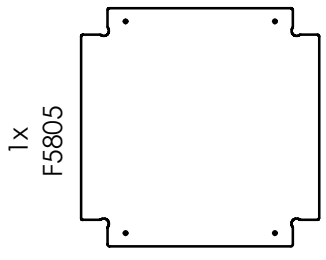
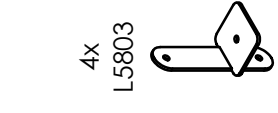
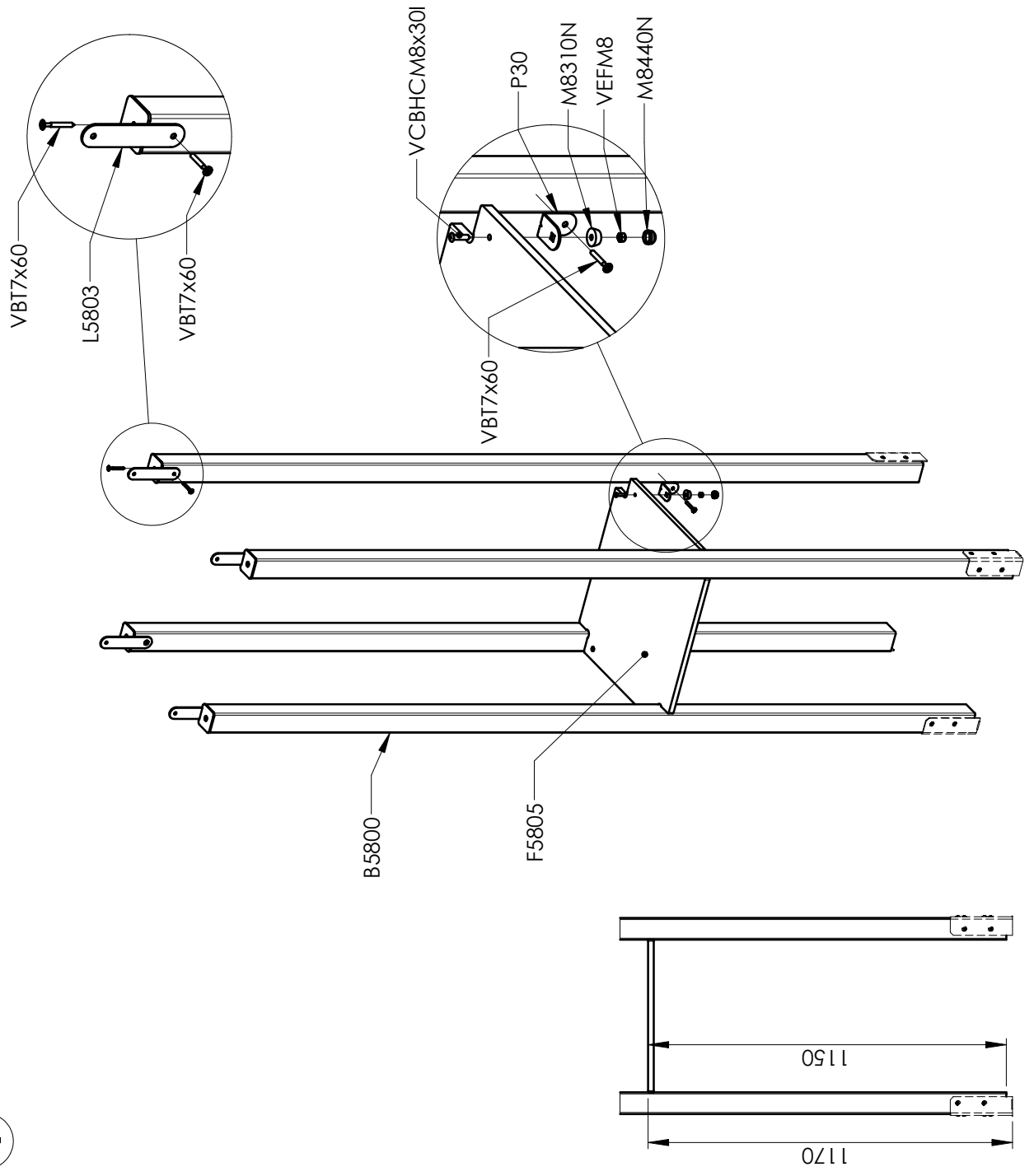

B5800	4
F5805	1
L5803	4
M8310N	10
M8440N	10
P30	4
U5805	2
VBT7x60	12
VCBHCM8x30I	4
VCBHCM8x60I	6
VEFM8	10

2

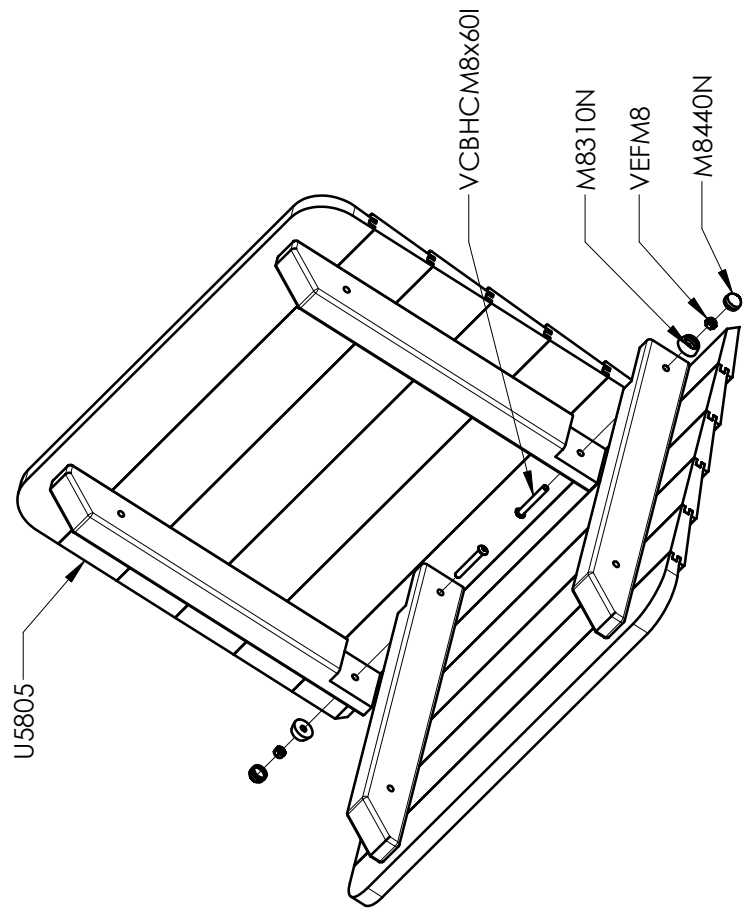

3

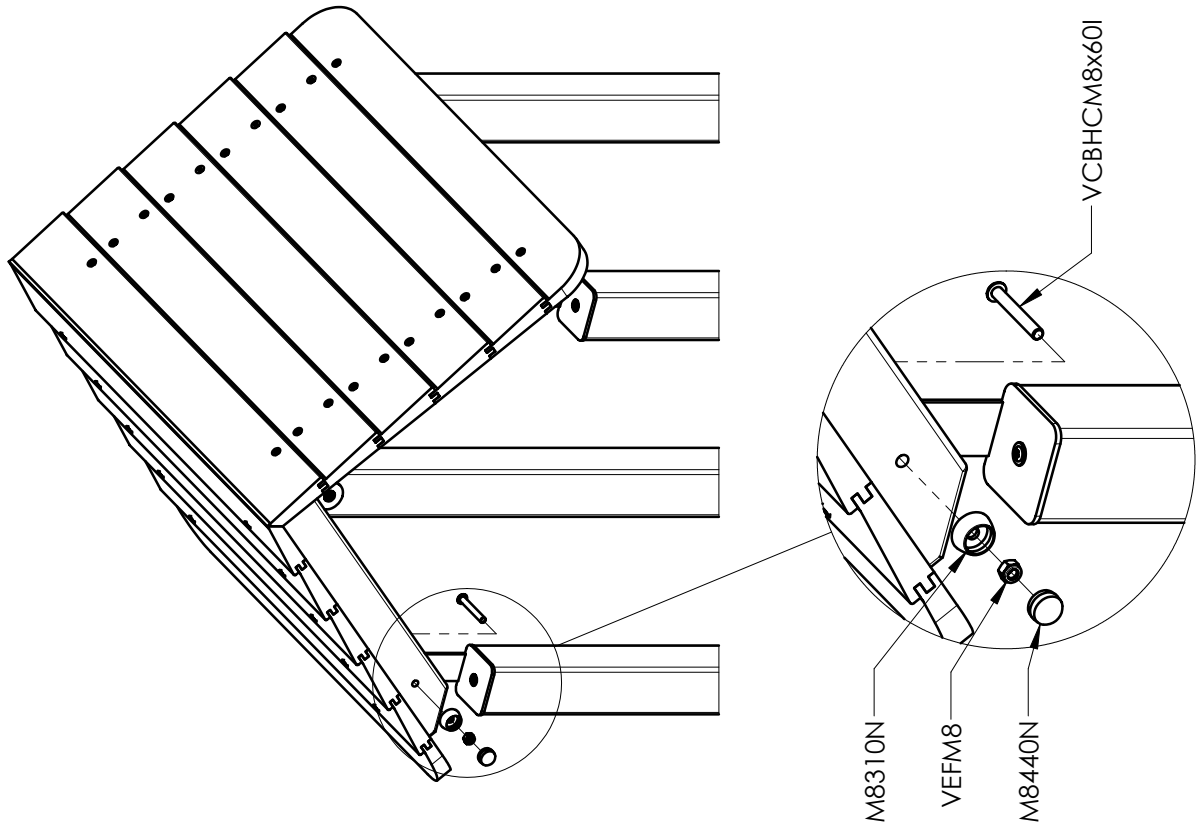

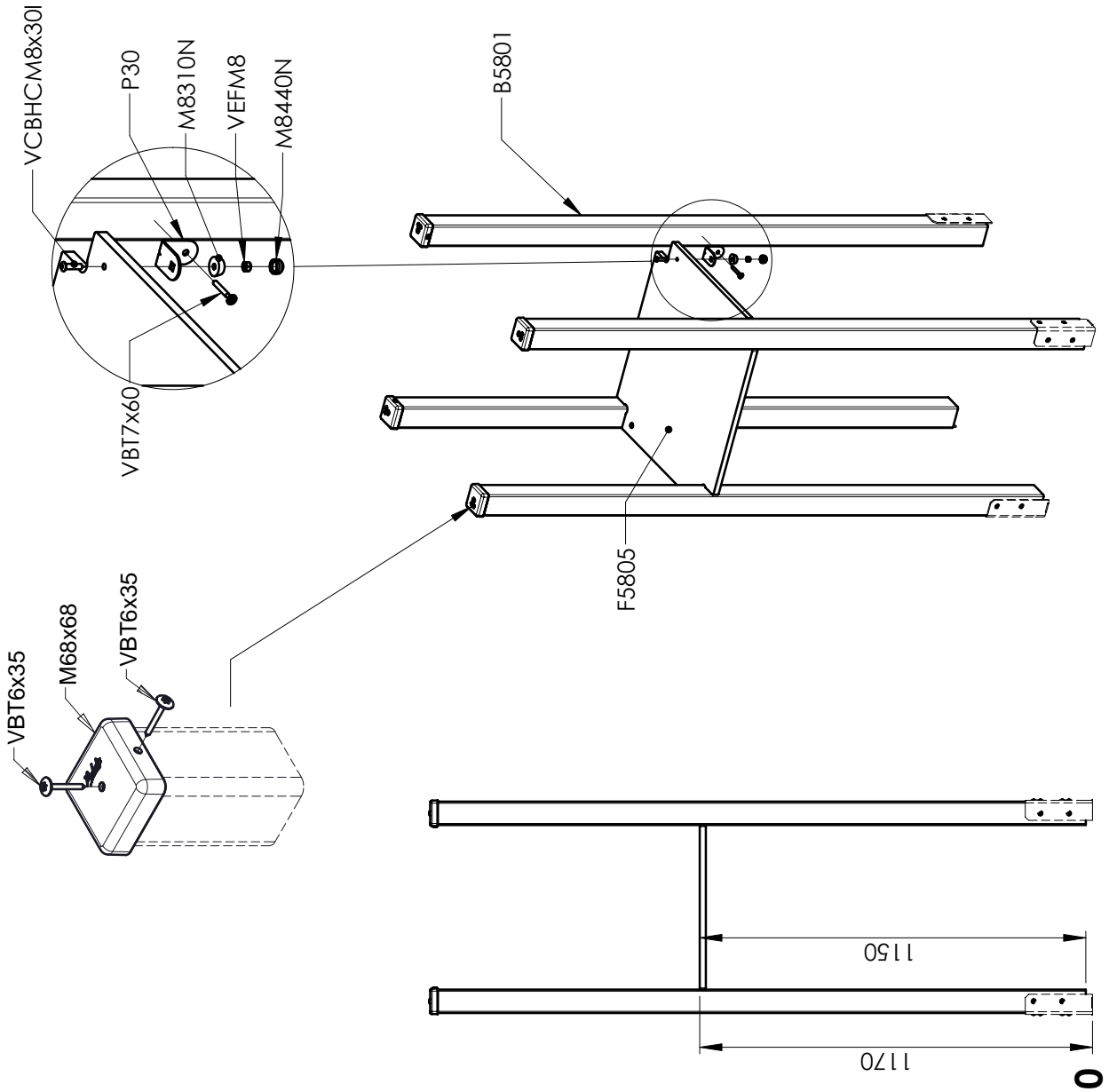

1x
F5805

4x
B5801

4x
P30

4x
M68x68

B5801	4
F5805	1
M68x68	4
M8310N	4
M8440N	4
P30	4
VBT6x35	8
VBT7x60	4
VCBHCM8x30I	4
VEFM8	4

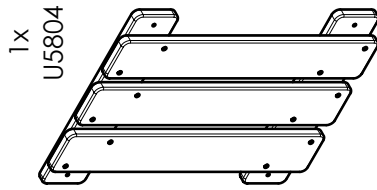
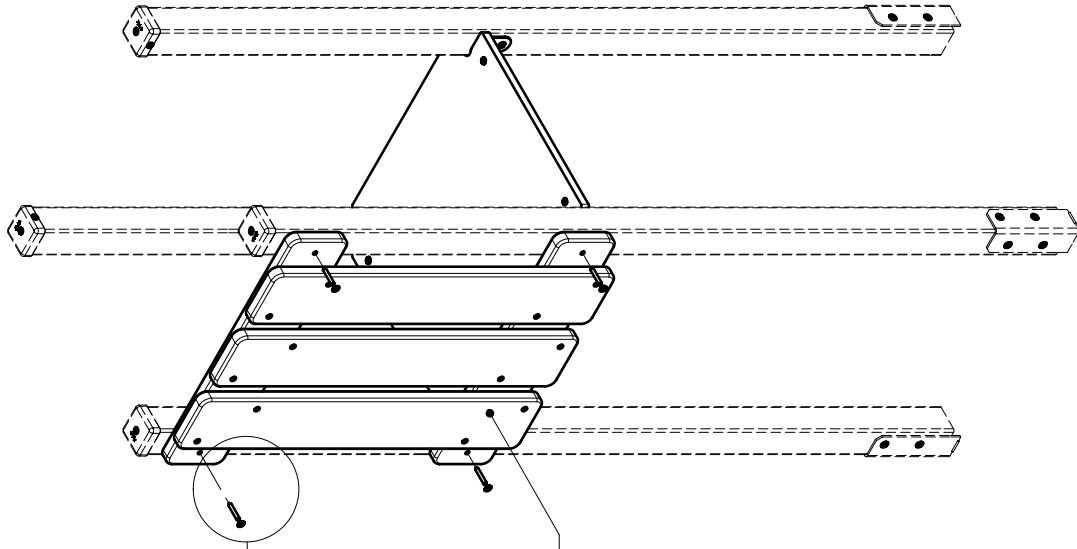

1 x
U5804

U5804

VB77x60

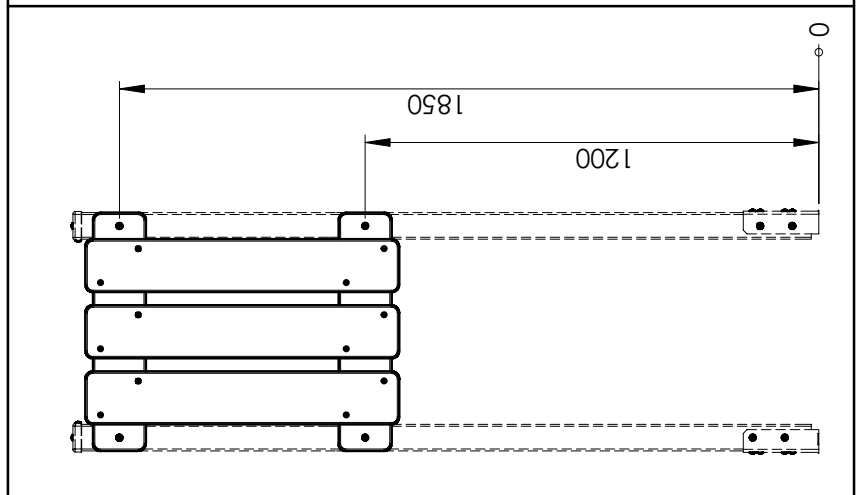
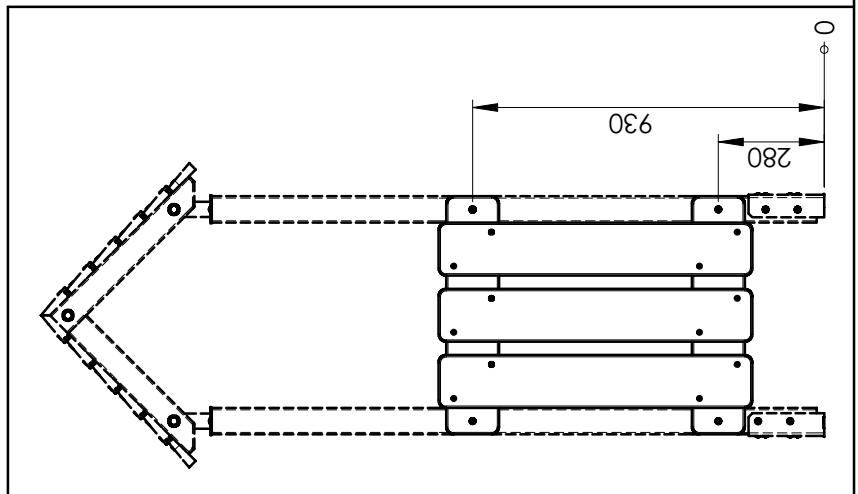

U5804	1	
VB77x60		4

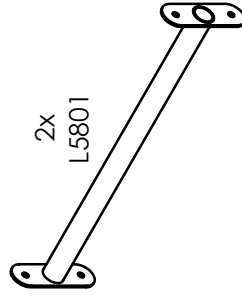
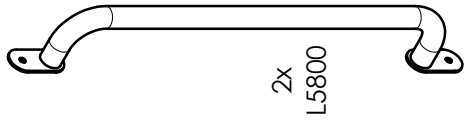
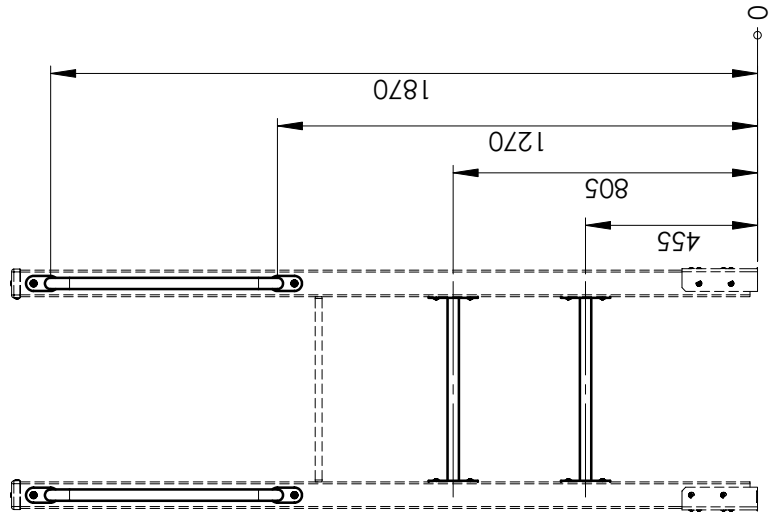
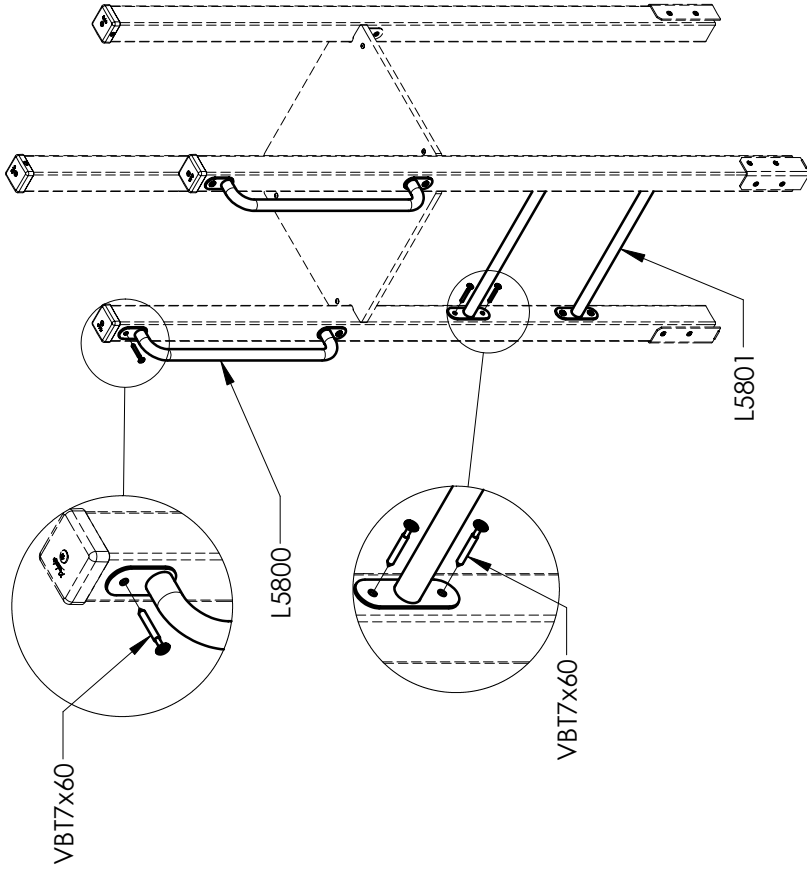

L5800	2
L5801	2
VB7x60	12

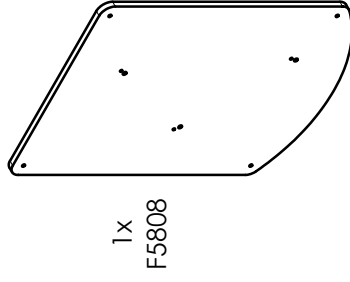
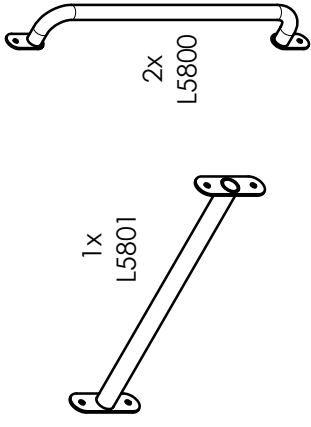
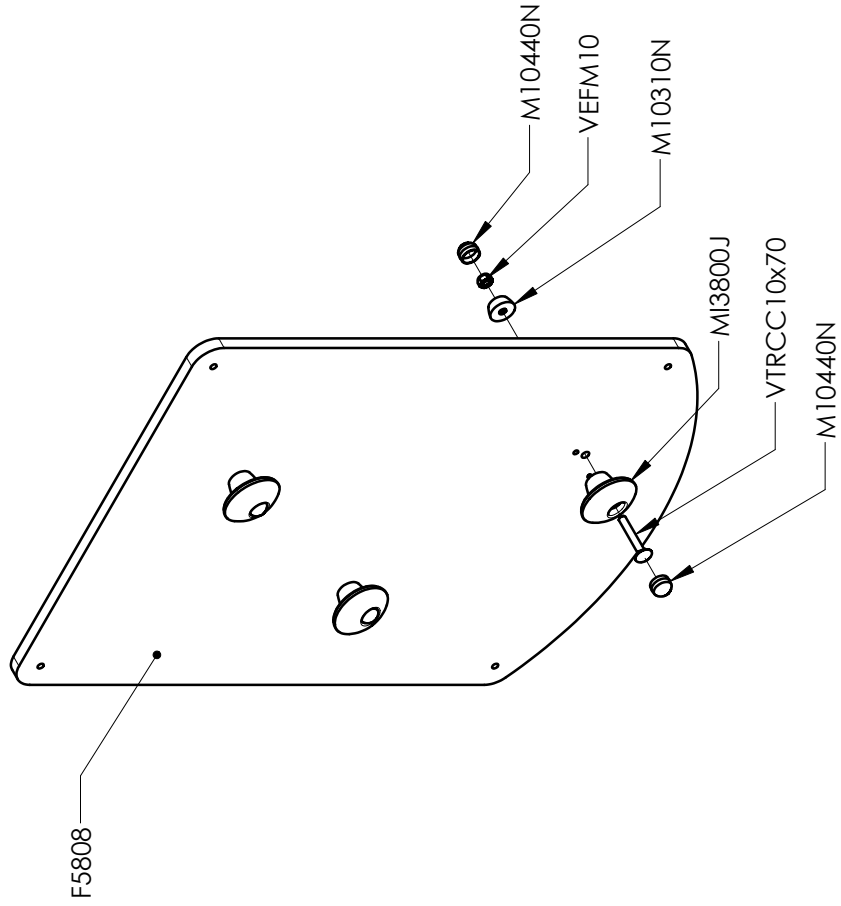

F5808	1
L5800	2
L5801	1
M10310N	3
M10440N	6
MI3800J	3
VB7x60	12
VEFM10	3
VTRCC10x70	3

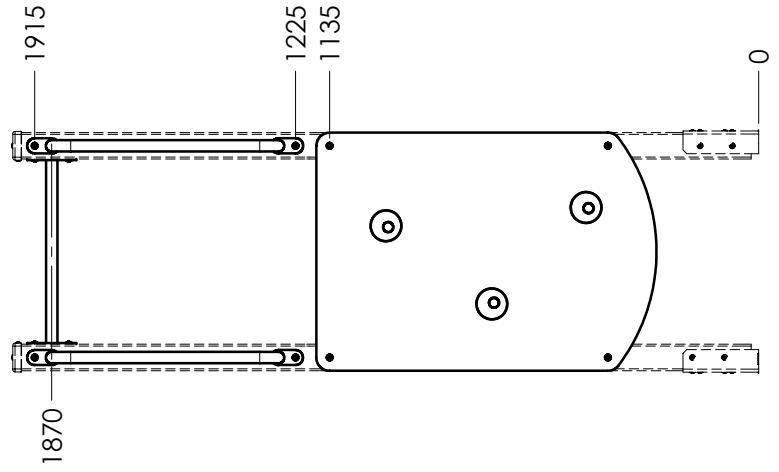
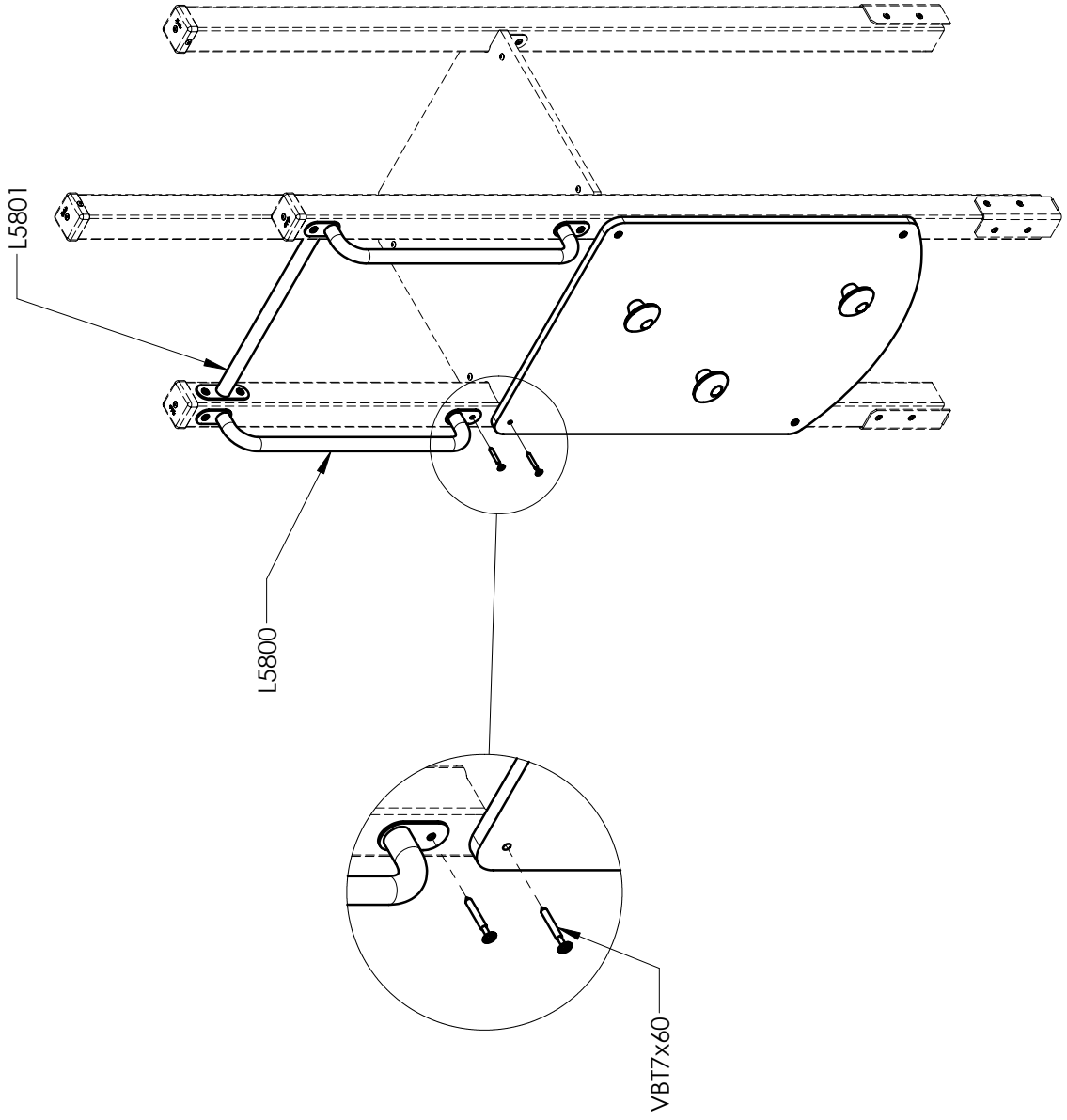

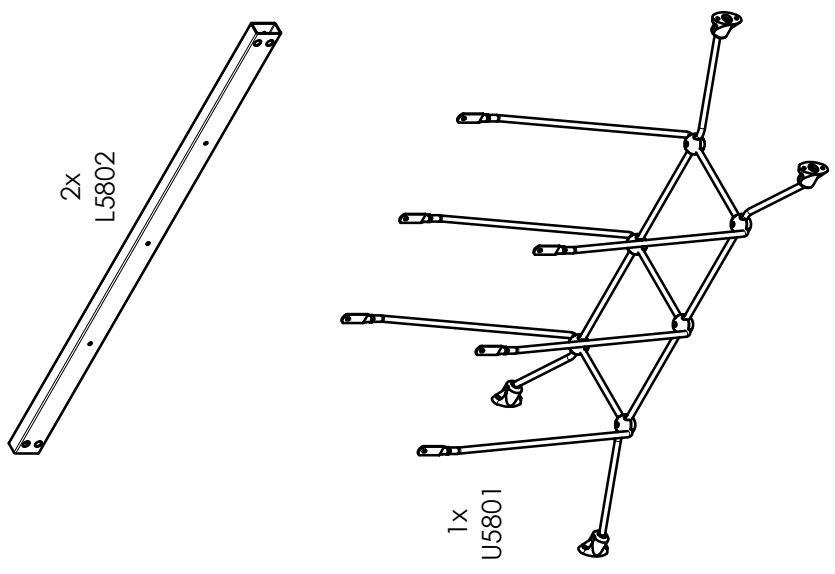
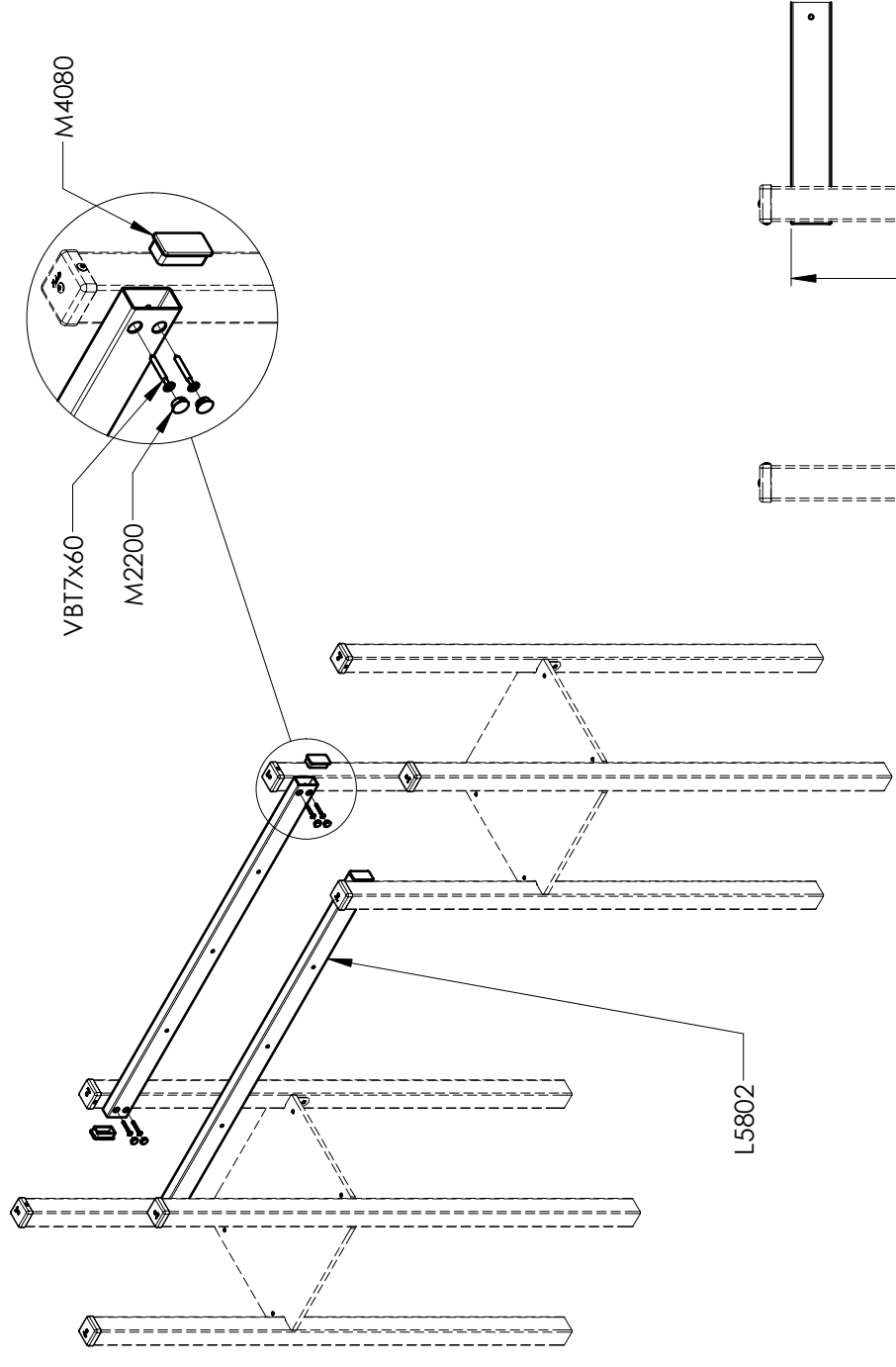

L5802	2
M2200	8
M4080	4
M8310N	6
M8440N	6
U5801	1
VBT7x60	16
VCBHC M8x60I	6
VEFM8	6

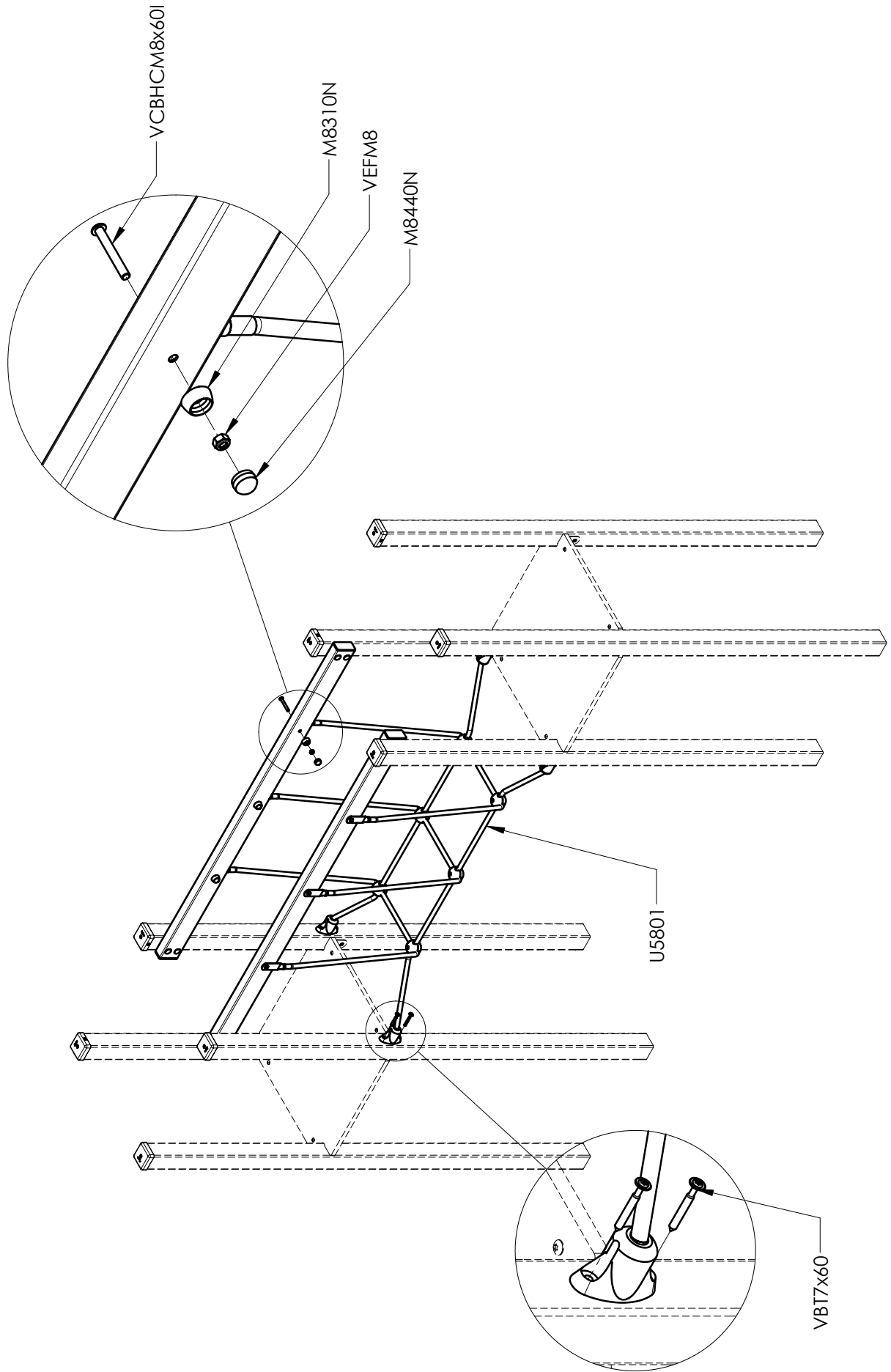

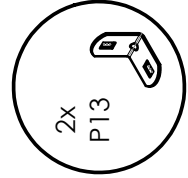
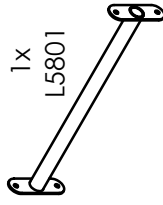
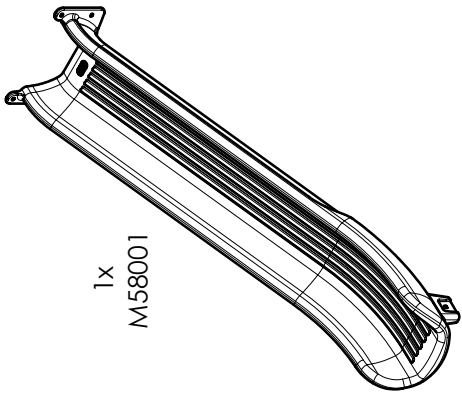
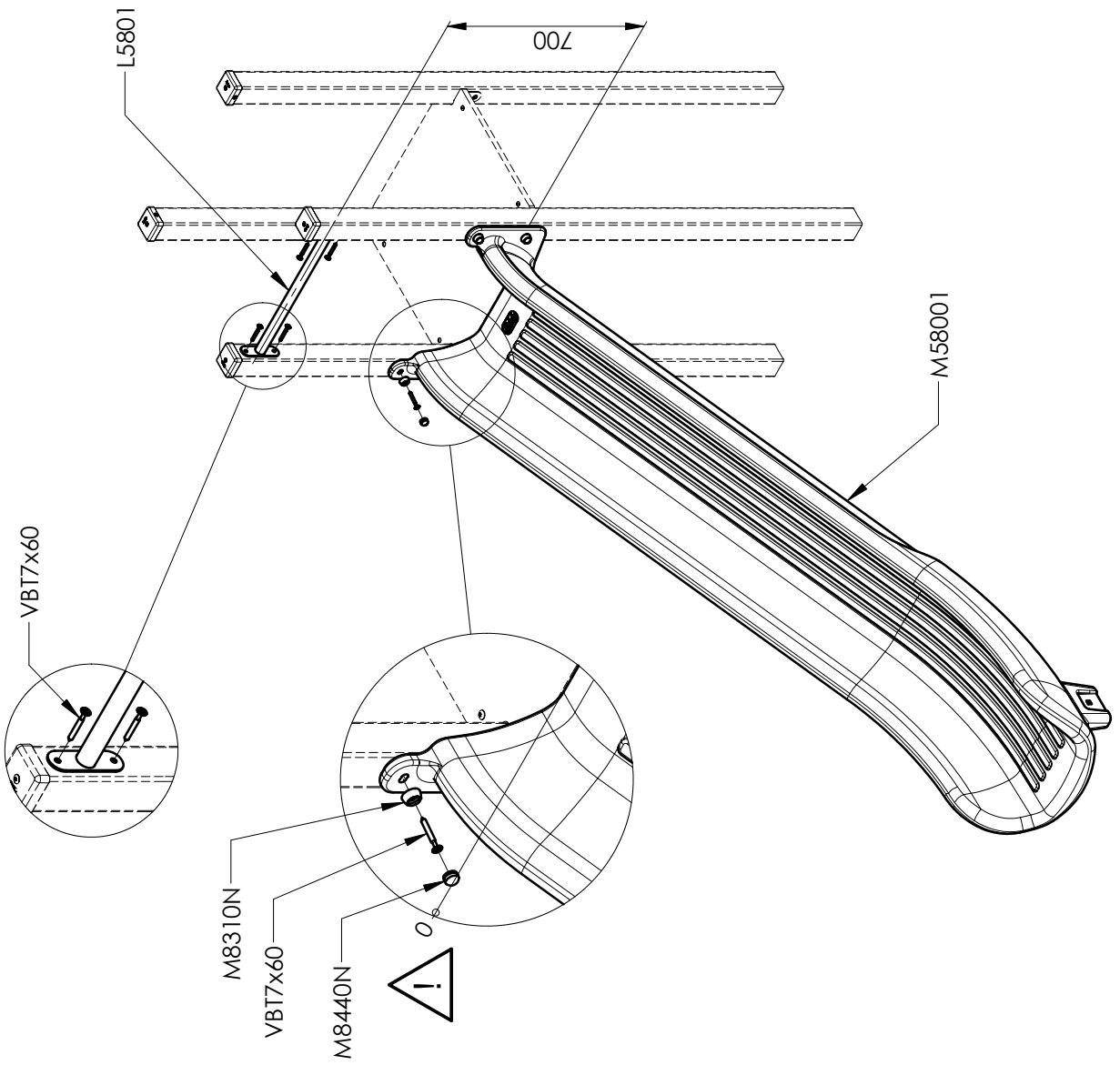

L5801	1
M8310N	4
M8440N	4
M10310N	2
M10440N	2
M58001	1
VBT7x60	8
VCBHC M10x20I	2

A

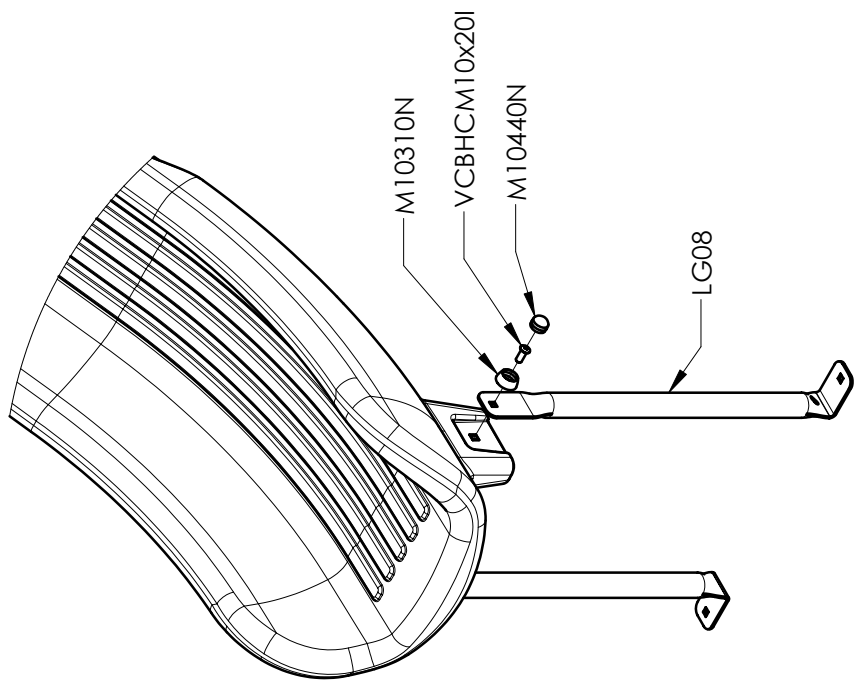
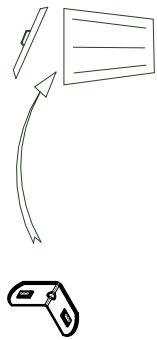

B

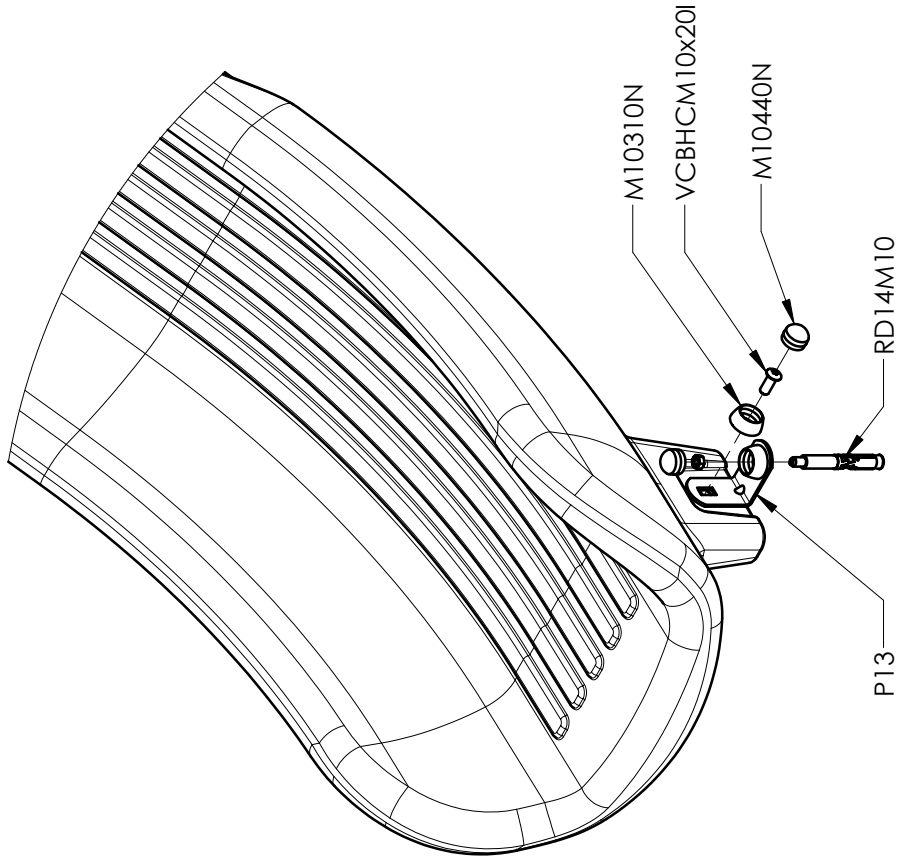
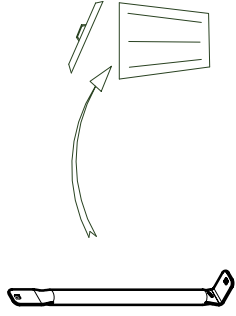

A

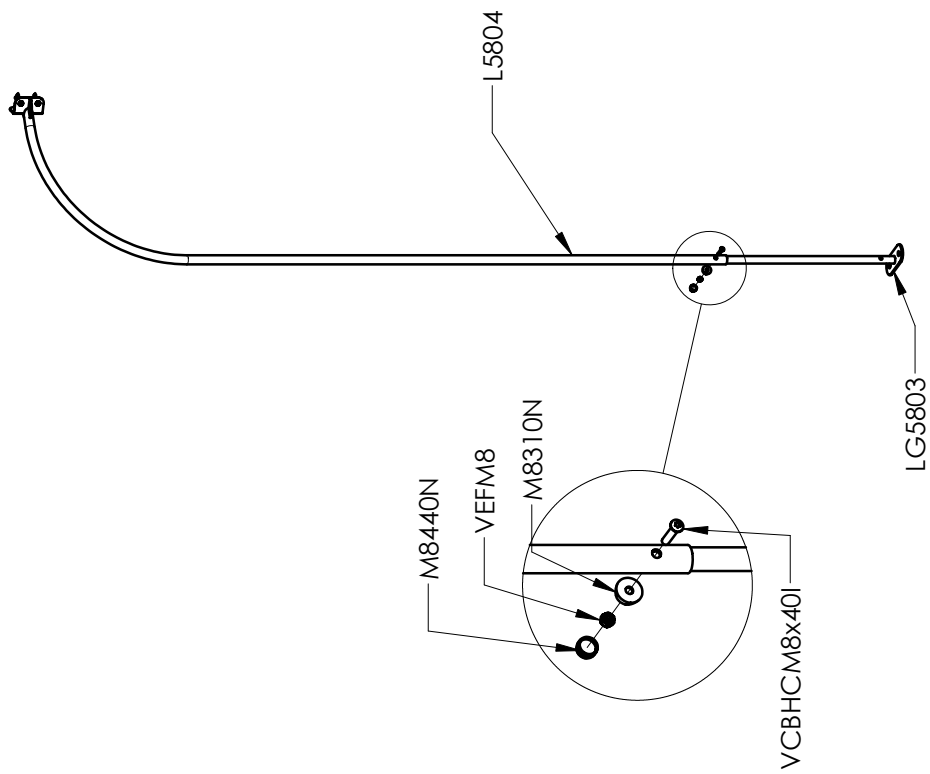

B

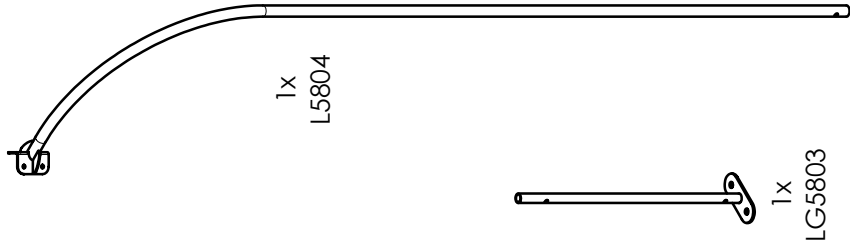
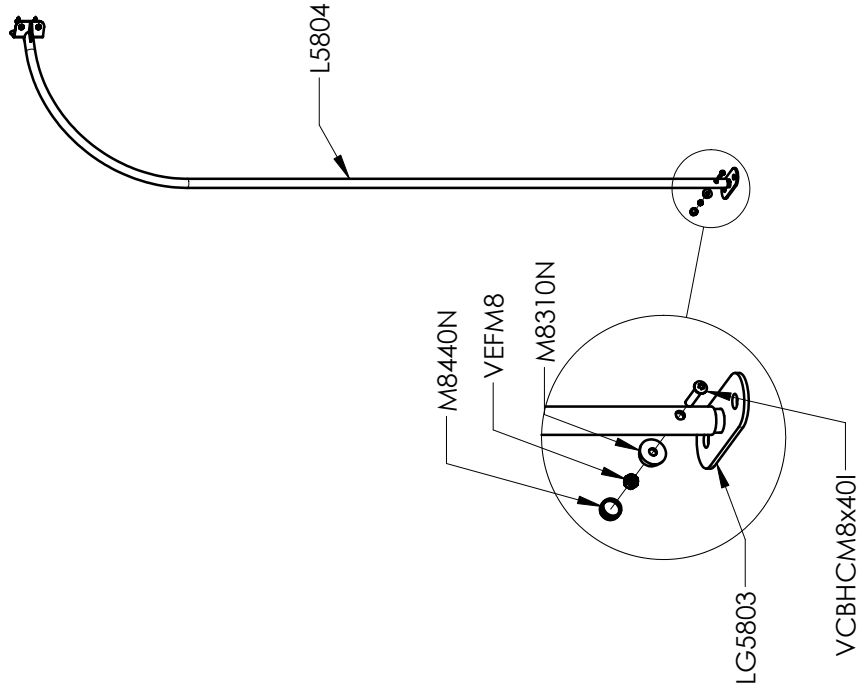

L5804	1
M8310N	1
M8440N	1
VB7x60	4
VCBHCM8x40I	1
VEFM8	1

